

Appendices

Appendix A – Planning Review Checklist

Appendix B – Figures

Figure 1 – Typical Minor Street Section

Figure 2 – Plain Cement Concrete Curb

Figure 3 – Plain Cement Concrete Curb Transition

Figure 4 – Concrete Walk Detail

Figure 5 – Wheelchair Ramp – Single Curb Cut

Figure 6 – Wheelchair Ramp - Double Curb Cut

Figure 7 – Driveway Paving Details

Figure 8 – Private Road Paving Details

Figure 9 – Typical Driveway W/ Trench Drain & Dry Sump Pump Detail

Figure 10 – Standard Bedding For Stormwater Piping

Figure 11 – Concrete Endwall

Figure 12 – Type “C” Inlet

Figure 13 – Type “M” Inlet

Figure 14 – Pavement Treatment At Inlet Location

Figure 15 – Slant Curb Transition To Type “C” Inlet

Figure 16 – Precast Concrete Manhole

Figure 17 – Stop Sign Detail

Figure 18 – Street Name Sign Detail

Figure 19 – No Parking Symbol Sign Detail

Figure 20 – Deciduous Shade & Flowering Tree Detail

Figure 21 – Cul-De-Sac Without Island

Figure 22 – Typical Bituminous Concrete Wedge Curb

Figure 23 – Pipe Underdrain/Pavement Base Drain

Figure 24 – Superpave HMA Trench Repair

Figure 25 – Type M Inlet (Frame & Bicycle Safe Grate)

Figure 26 – Parking Configurations

Figure 27 – Typical Signature Block

Appendix C – Recommended Tree and Shrub List

APPENDIX A

APPENDIX B

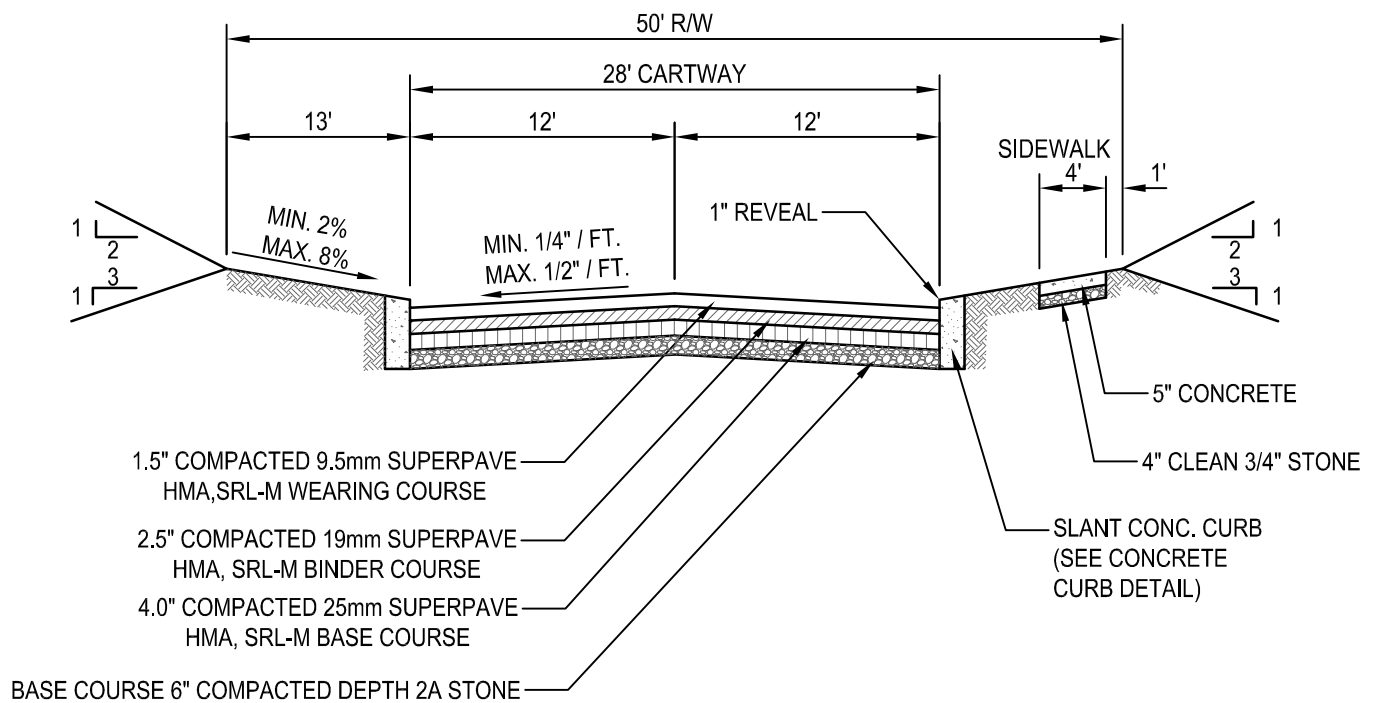

NOTE:

- COLLECTOR STREETS REQUIRE A MINIMUM 60' R.O.W. AND 36' CARTWAY WIDTH
- ARTERIAL STREETS REQUIRE A MINIMUM 80' R.O.W. AND VARIABLE CARTWAY WIDTH AS DETERMINED BY THE TOWNSHIP BASED ON LOCAL CONDITIONS
- BASED ON SITE CONDITIONS, THE TOWNSHIP MAY REQUIRE INSTALLATION OF A SUBDRAINAGE SYSTEM.

TYPICAL MINOR STREET SECTION

CSE | CLARK SURVEYING
ENGINEERING

83 East Fifth Avenue, Suite 2, Everett, Pennsylvania 15537
Phone: 814.652.2488 Fax: 1.866.381.4127
Website: www.CSE4078.com

WEST PROVIDENCE TOWNSHIP, BEDFORD COUNTY, PENNSYLVANIA

CONSTRUCTION AND MATERIAL SPECIFICATIONS

2" DEEP, 3/16" WIDE CAULK
WITH POLYURETHANE
CONCRETE CAULK

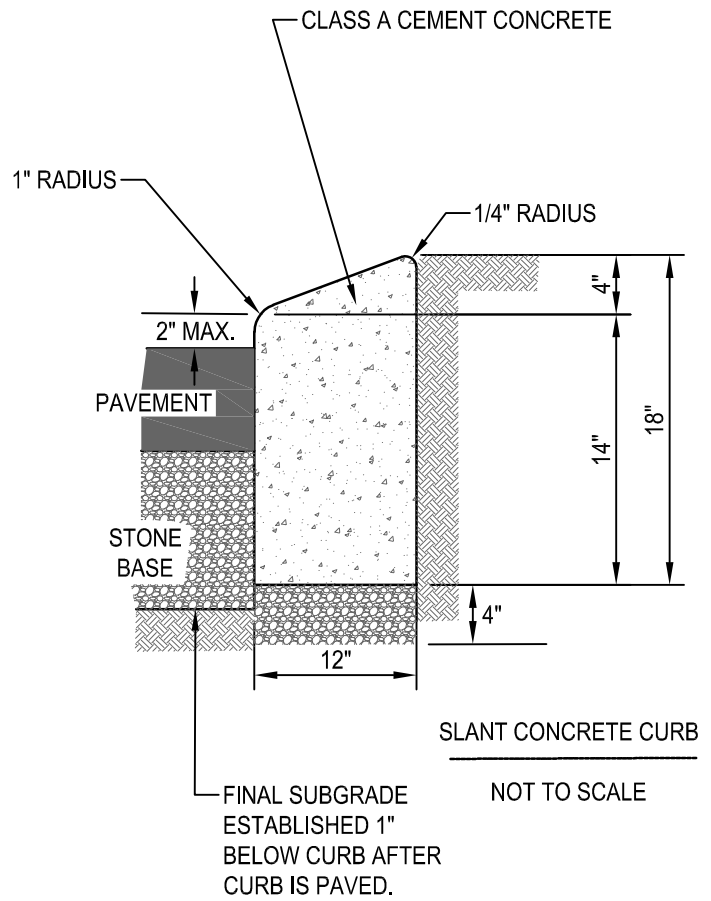
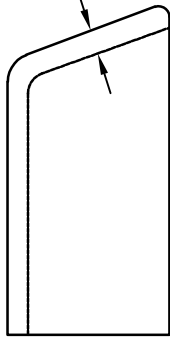

DETAIL "A"
CONTRACTION JOINT

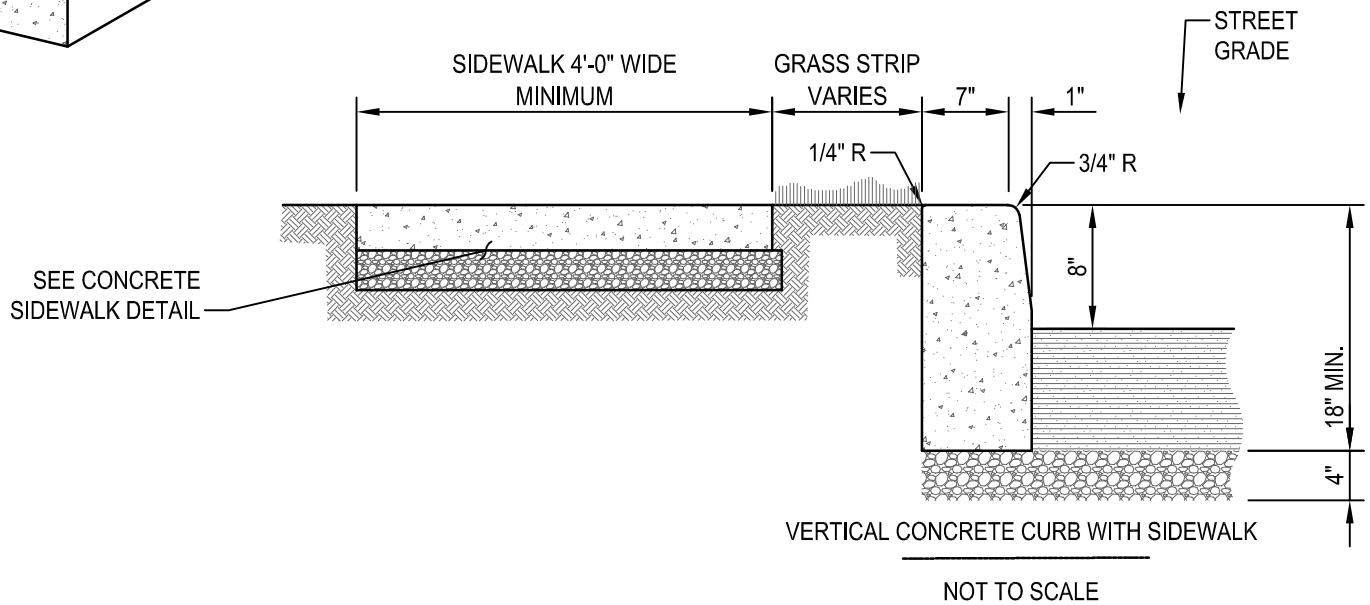
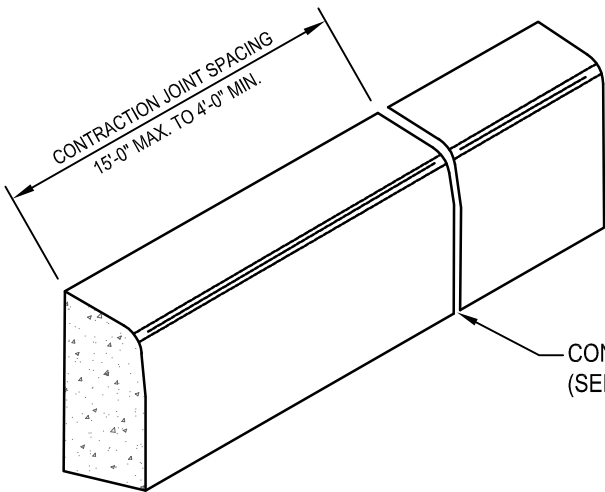

PLAIN CEMENT CONCRETE CURB

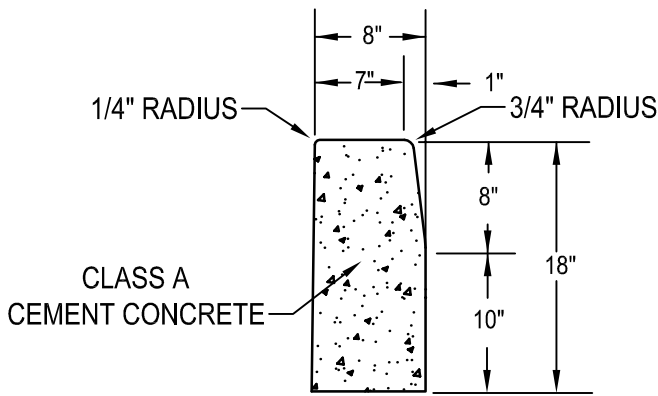

TYPICAL CROSS SECTION

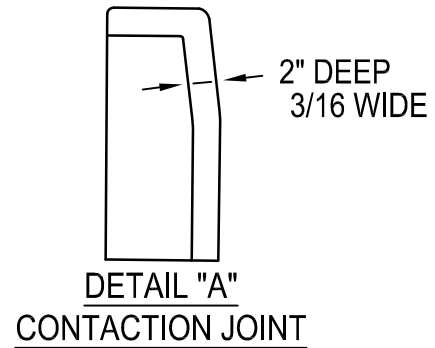

DETAIL "A"
CONTRACTION JOINT

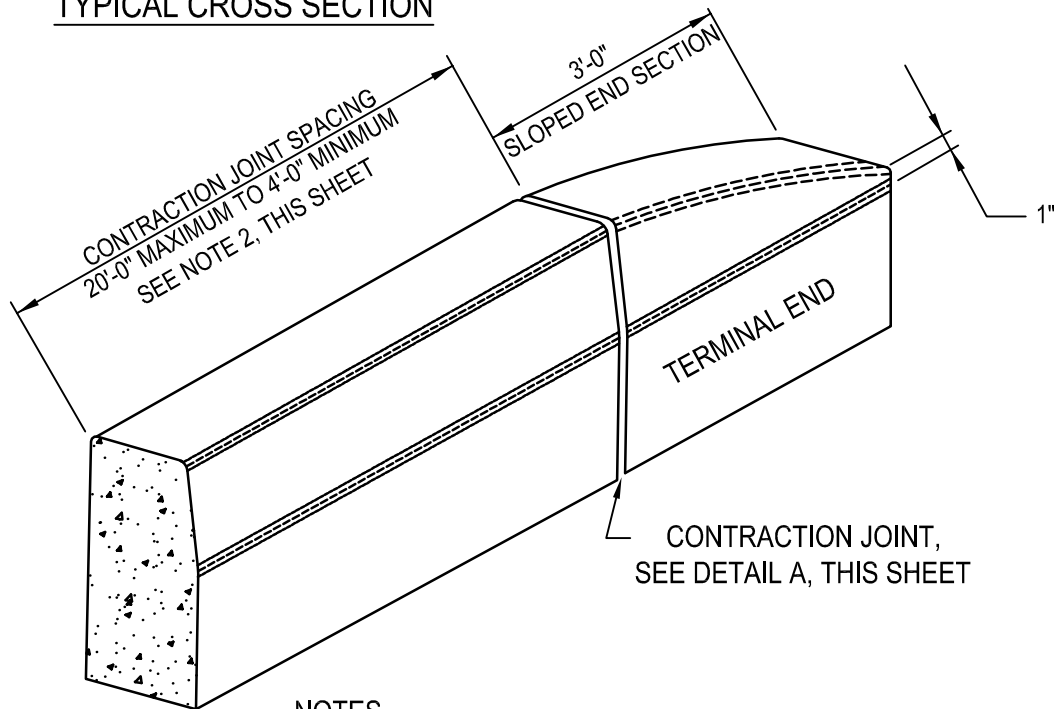

NOTES

1. MATERIALS AND CONSTRUCTION SHALL MEET THE REQUIREMENTS OF PUBLICATION 408, SECTION 630 FOR PLAIN CEMENT CONCRETE CURB.
2. SPACE CONTRACTION JOINTS IN UNIFORM LENGTHS OR SECTIONS. SEE DRAWING NO. 2.
3. PLACE 3/4-INCH PREMOLDED EXPANSION JOINT FILLER MATERIAL AT STRUCTURES AND AT THE END OF THE WORK DAY. CUT MATERIAL TO CONFORM TO CROSS SECTIONAL AREA OF CURB.

TERMINAL END SECTION

NOT TO SCALE

PLAIN CEMENT CONCRETE CURB TRANSITION

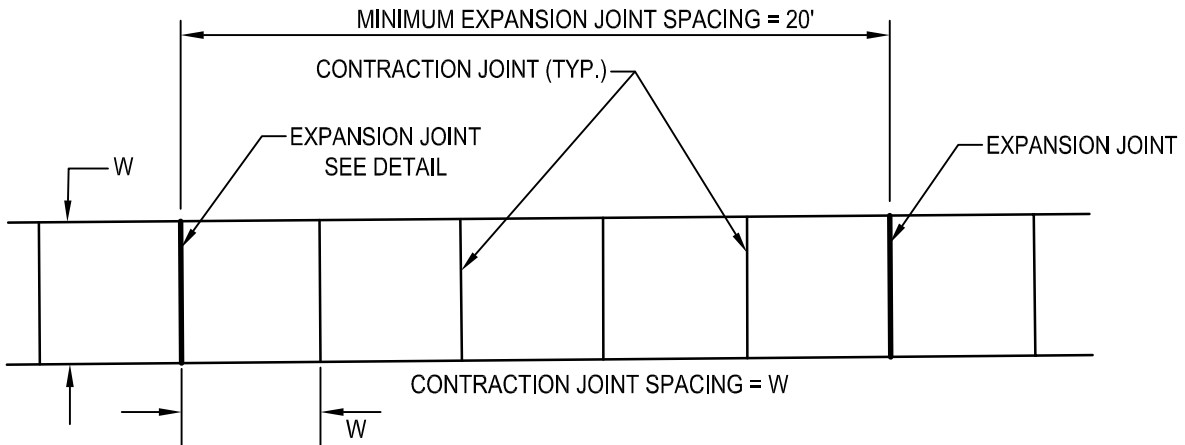
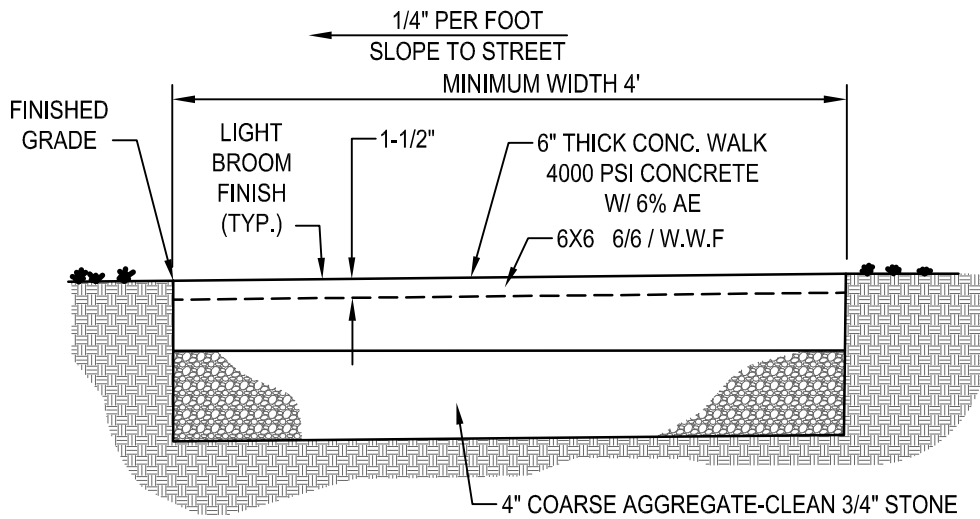

- NOTES:
1. JOINT SPACING TO MATCH SIDEWALK (W)
 2. SIDEWALK WIDTH (W) TO BE DESIGNATED ON DRAWINGS. (MIN. 4')
 3. INSTALL EXPANSION MATERIAL AROUND ALL STRUCTURES EXISTING AND PROPOSED AND AS DIRECTED BY THE TOWNSHIP
 4. UTILIZE THE ABOVE JOINT PATTERN UNLESS OTHERWISE DETAILED ON THE DRAWINGS OR DIRECTED BY THE TOWNSHIP

CONCRETE SIDEWALK TYPICAL JOINT SPACING

CONCRETE WALK DETAIL

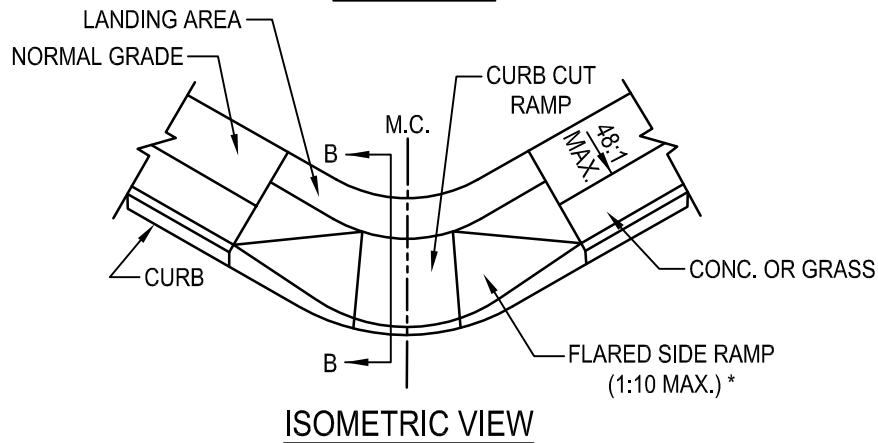
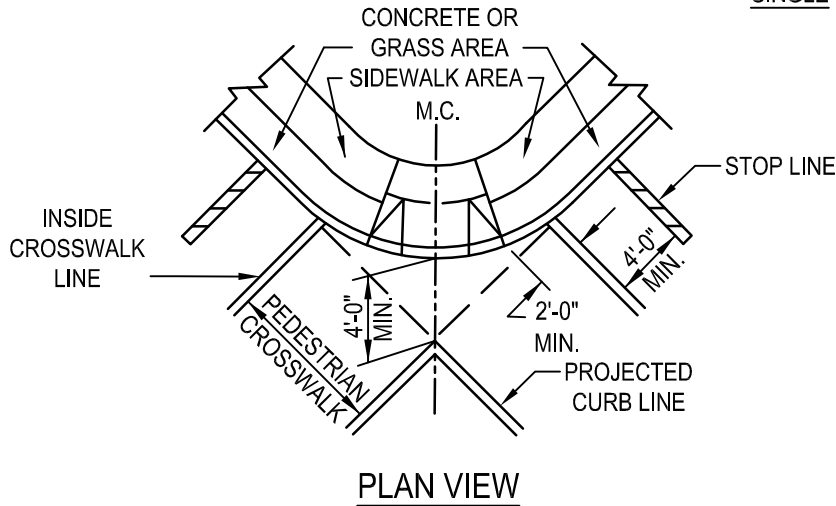
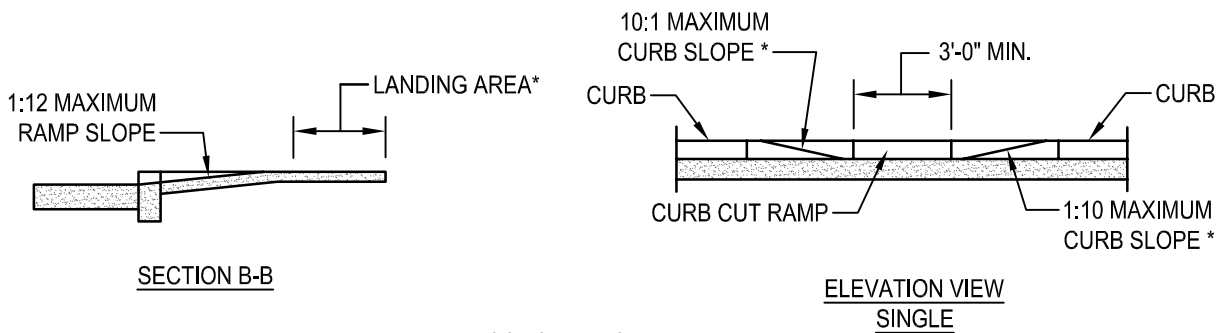

SINGLE CURB CUT RAMP
NO SCALE

* IF LANDING AREA IS LESS THAN 48", THEN THE SLOPE OF THE FLARED SIDE SHALL NOT EXCEED 1:12

NOTE: TRANSITIONS FROM RAMPS TO WALKS, GUTTERS, OR STREETS SHALL BE FLUSH AND FREE OF ABRUPT CHANGES. MAXIMUM SLOPES OF ADJOINING GUTTERS, ROAD SURFACE IMMEDIATELY ADJACENT TO THE CURB CUT RAMP SHALL NOT EXCEED 1:20.

WHEELCHAIR RAMP AT CURB

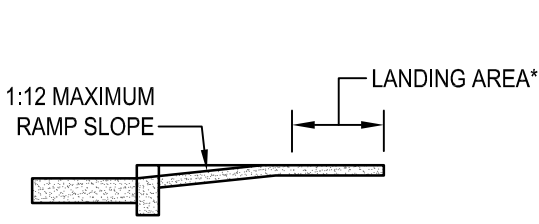

SECTION B-B

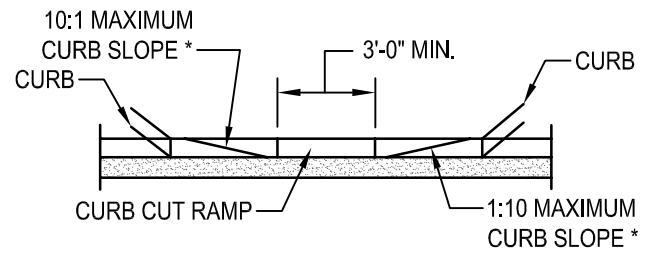

ELEVATION VIEW
DOUBLE

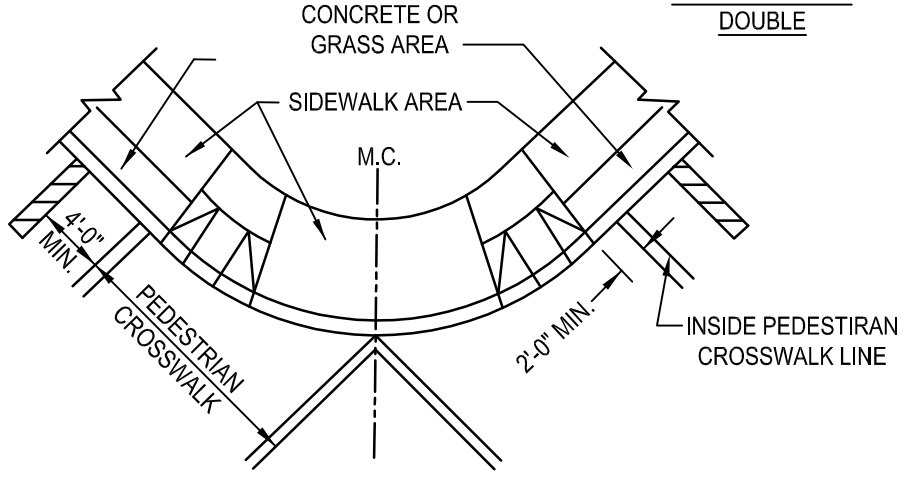

PLAN VIEW

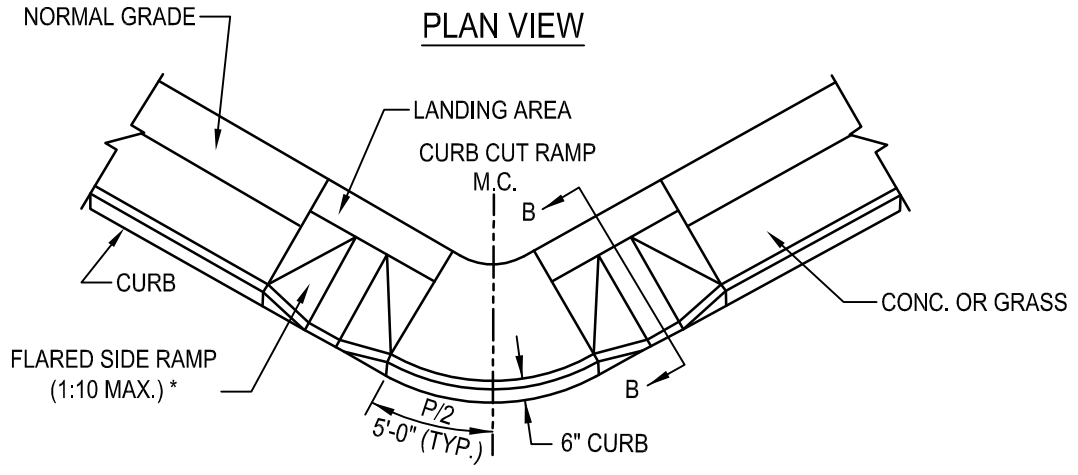

ISOMETRIC VIEW

DOUBLE CURB CUT RAMP
NO SCALE

* IF LANDING AREA IS LESS THAN 48", THEN THE SLOPE OF THE FLARED SIDE SHALL NOT EXCEED 1:12

NOTE: TRANSITIONS FROM RAMPS TO WALKS, GUTTERS, OR STREETS SHALL BE FLUSH AND FREE OF ABRUPT CHANGES. MAXIMUM SLOPES OF ADJOINING GUTTERS, ROAD SURFACE IMMEDIATELY ADJACENT TO THE CURB CUT RAMP SHALL NOT EXCEED 1:20.

WHEELCHAIR RAMP AT CURB

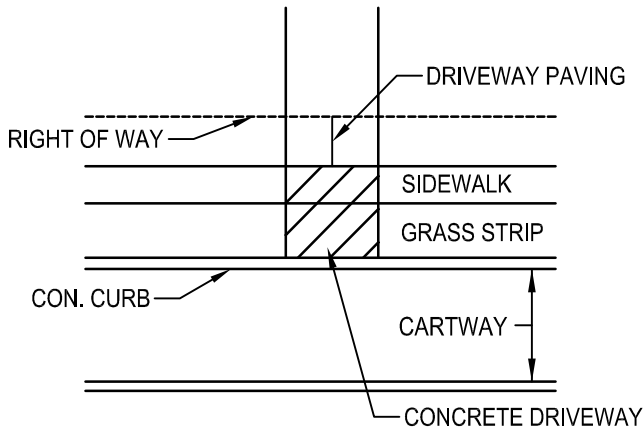

**DRIVEWAY PAVING
WITH CONCRETE
SIDEWALK**

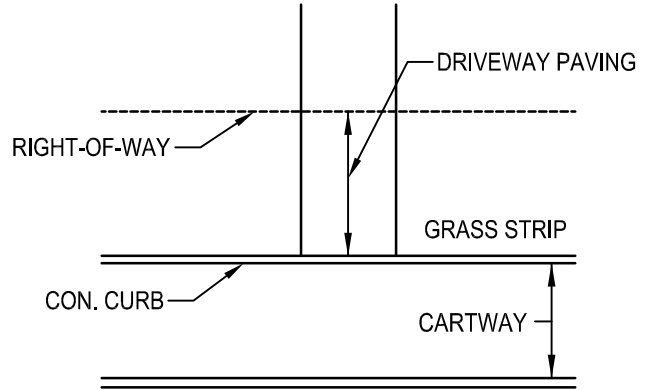

**DRIVEWAY PAVING
NO SIDEWALK**

PLAN

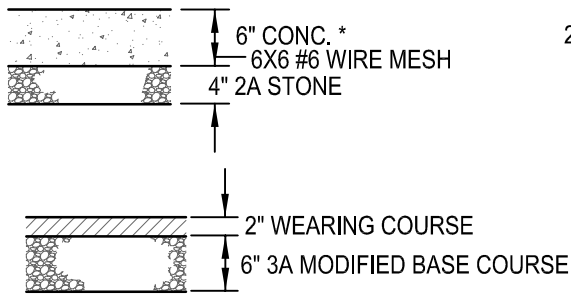

RESIDENTIAL

* 8" FOR COMMERCIAL

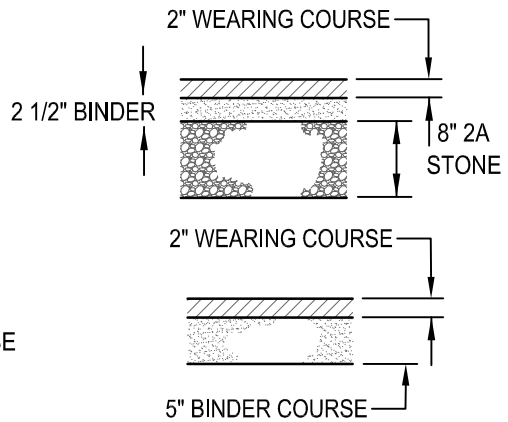

**COMMERCIAL
DRIVEWAY PAVING**

TYPICAL SECTION

NOTE: ALL DRIVEWAYS SHALL HAVE A BITUMINOUS OR CONCRETE SURFACE WITHIN ASPHALT PAVED STREET RIGHT-OF-WAY

DRIVEWAY PAVING DETAILS

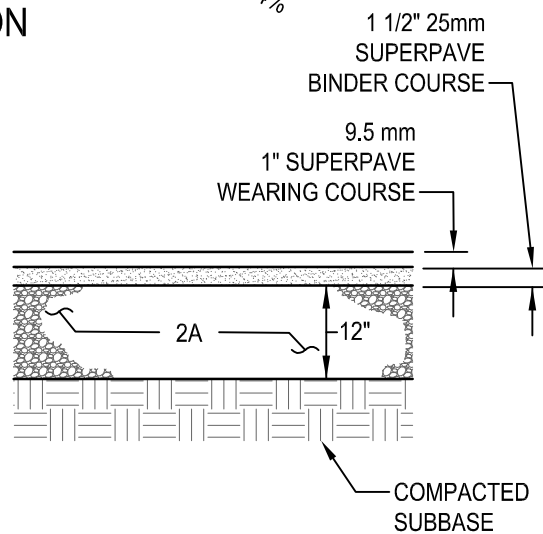
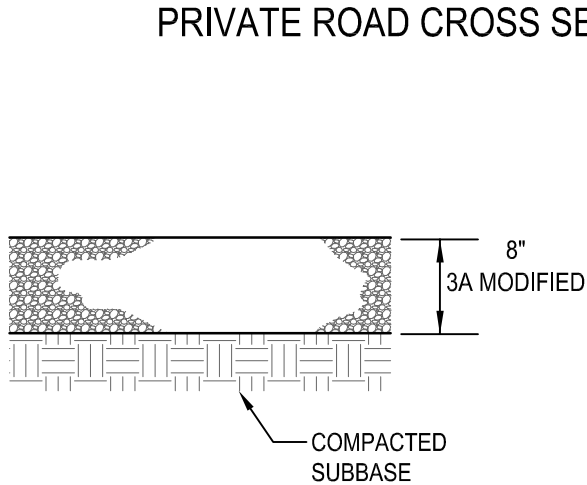
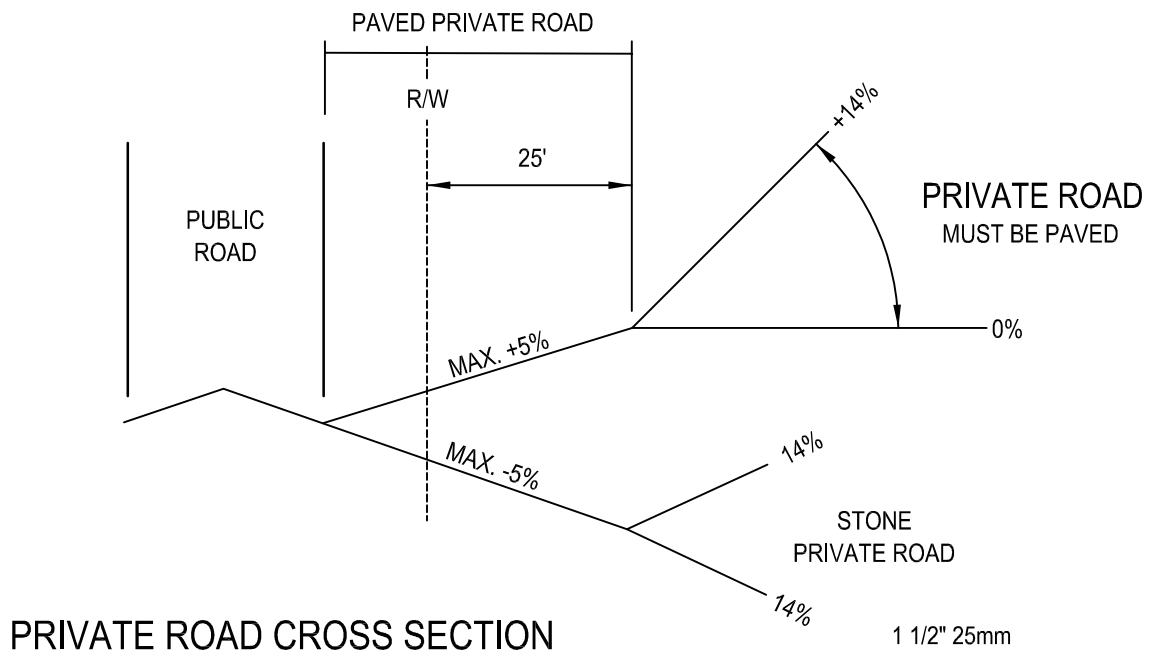

PRIVATE ROAD PAVING DETAILS

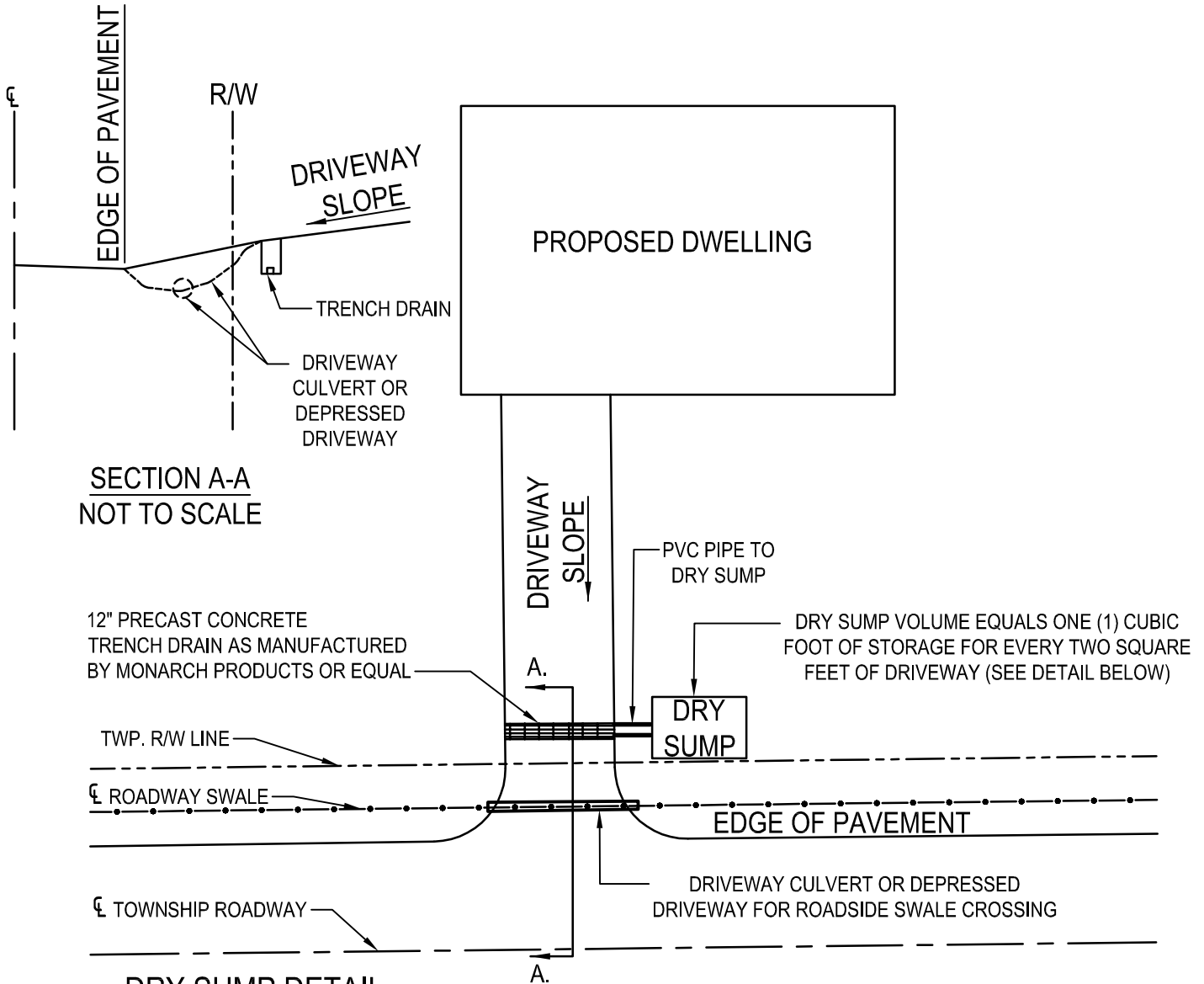

SECTION A-A
NOT TO SCALE

12" PRECAST CONCRETE
TRENCH DRAIN AS MANUFACTURED
BY MONARCH PRODUCTS OR EQUAL

DRY SUMP VOLUME EQUALS ONE (1) CUBIC
FOOT OF STORAGE FOR EVERY TWO SQUARE
FEET OF DRIVEWAY (SEE DETAIL BELOW)

DRY SUMP DETAIL
NO SCALE

PLAN
NOT TO SCALE

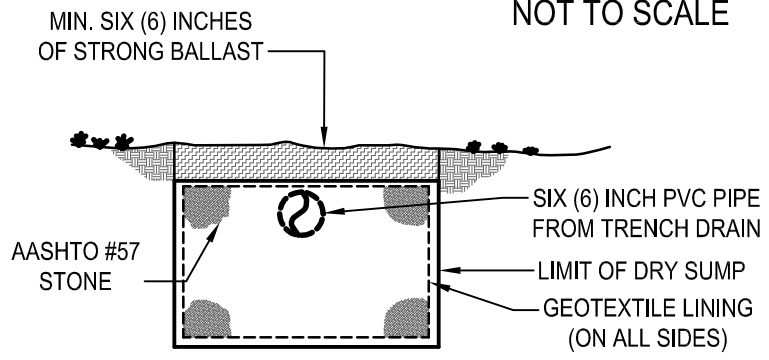

NOTES:

1. DRY SUMP AND TRENCH DRAIN TO BE LOCATED OUTSIDE OF TOWNSHIP RIGHT-OF-WAY.
2. DRY SUMP AND TRENCH DRAIN SYSTEM TO BE OWNED, OPERATED AND MAINTAINED BY EACH RESPECTIVE PROPERTY OWNER ON WHICH THE SYSTEM IS CONSTRUCTED.
3. MAINTENANCE, UNCLOGGING, AND REPAIRS SHALL BE THE RESPONSIBILITY OF THE INDIVIDUAL PROPERTY OWNER.

TYPICAL DRIVEWAY W/ TRENCH DRAIN & DRY SUMP PUMP DETAIL

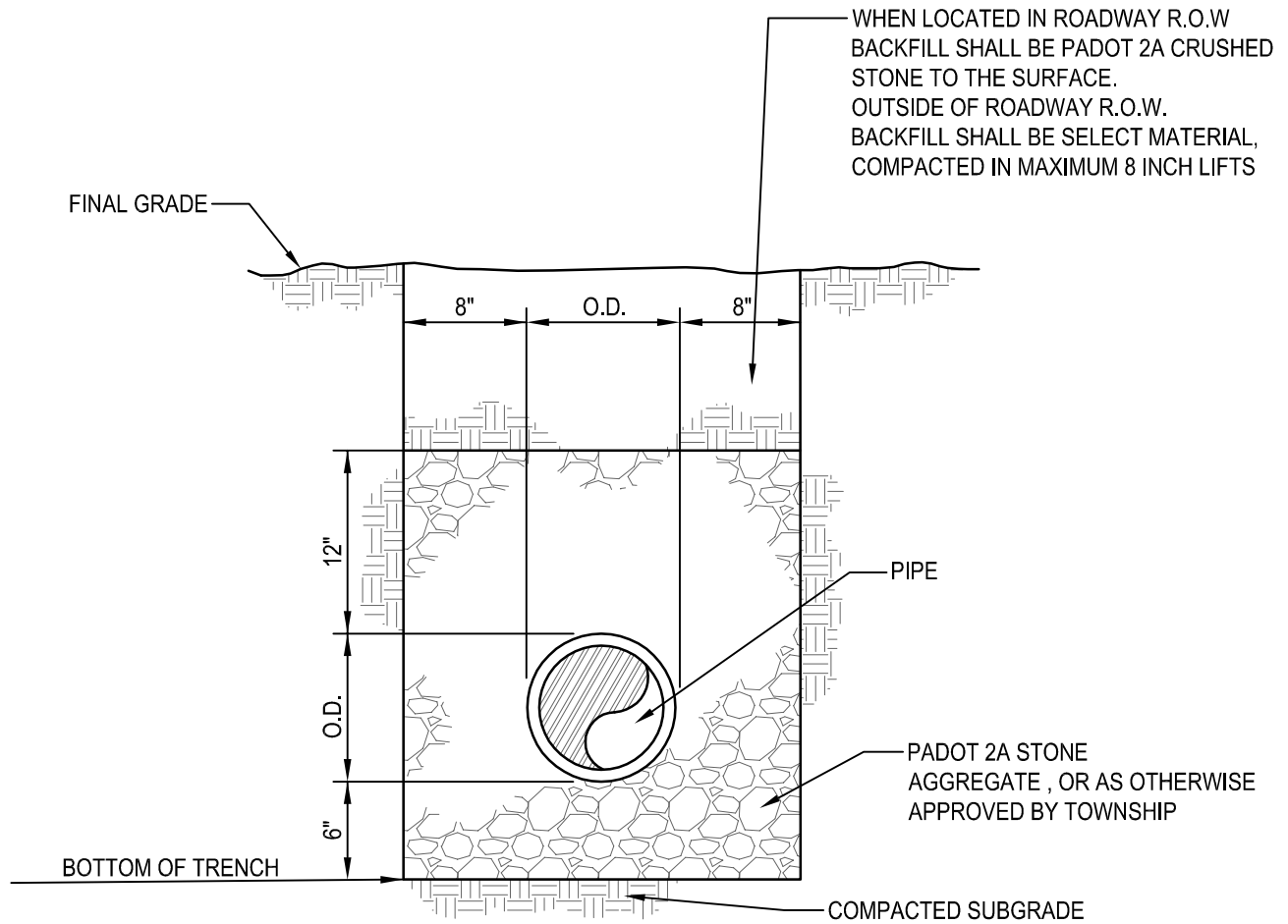

1. ALL PIPES SHALL BE BEDDED AS SHOWN ABOVE USING PADOT 2A STONE WITH THE EXCEPTION OF PVC PIPE, AND CONCRETE PIPE
2. BEDDING MATERIALS FOR ALL DIAMETERS OF PVC PIPE SHALL BE No. 1B STONE.
3. BEDDING MATERIALS FOR ALL DIAMETERS OF CONCRETE PIPE SHALL BE AASHTO NO. 8 STONE

STANDARD BEDDING FOR STORMWATER PIPING

CSE | CLARK SURVEYING
ENGINEERING

83 East Fifth Avenue, Suite 2, Everett, Pennsylvania 15537
Phone: 814.652.2488 Fax: 1.866.381.4127
Website: www.CSE4078.com

WEST PROVIDENCE TOWNSHIP, BEDFORD COUNTY, PENNSYLVANIA

CONSTRUCTION AND MATERIAL SPECIFICATIONS

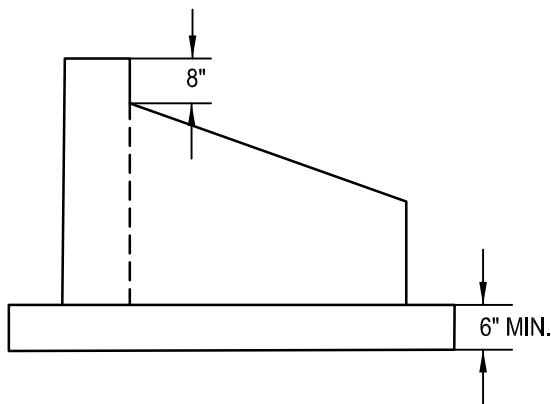
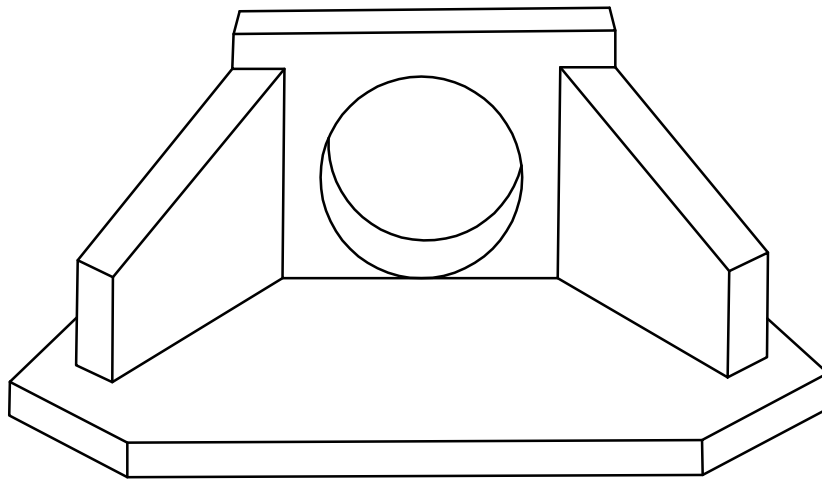

SIDE VIEW

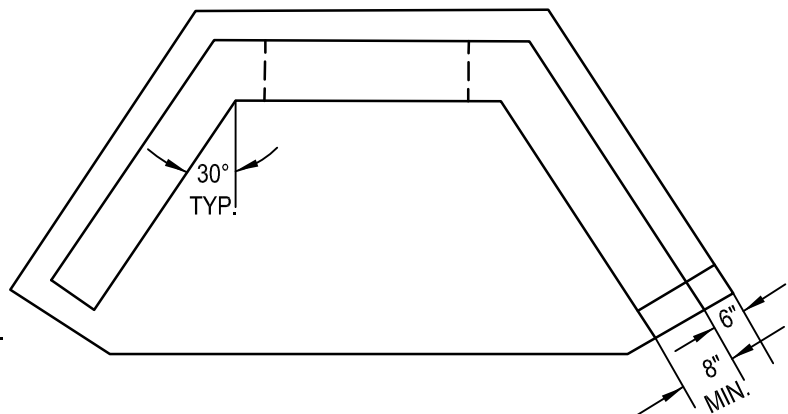

PLAN VIEW

NOTES:

1. ALL CONSTRUCTION SHALL BE IN ACCORDANCE WITH PA DOT PUBLICATION 408, SECTION 605 & STANDARDS FOR ROADWAY CONSTRUCTION, RC-31M. ENDWALL SIZING SHALL BE BASED ON PIPE SIZES & ALIGNMENT PRIOR TO ORDERING PRECAST STRUCTURES.
2. ALL DRAINAGE STRUCTURES SHALL HAVE POURED-IN-PLACE CONCRETE CHANNEL BOTTOMS.
3. CONCRETE SHALL BE CLASS "A".
4. EXPOSED EDGES SHALL BE CHAMFERED ONE (1) INCH.
5. PROVIDE CONCRETE APRON WHEN TRASH RACK IS PROPOSED ON HEADWALL.

CONCRETE ENDWALL

NOTE: WHEN LOCATED IN A PAVED STREET, GRATE SURFACE ELEVATION SHALL BE A MAXIMUM OF 1" AND A MINIMUM OF 1/2" BELOW THE SEALED FINISHED ROAD SURFACE

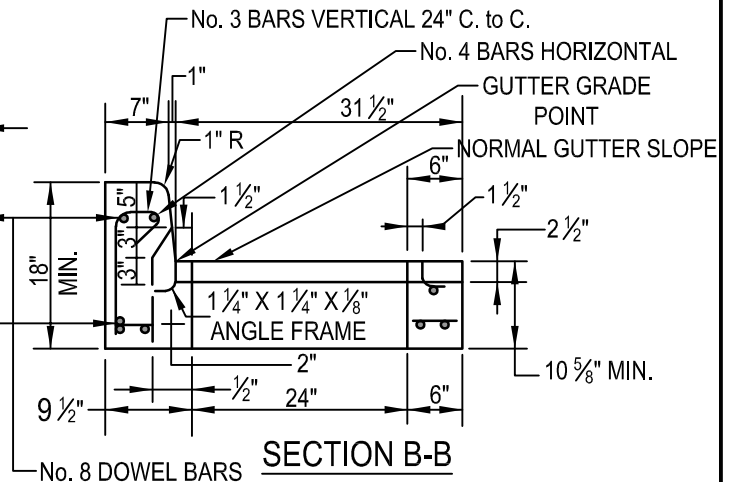
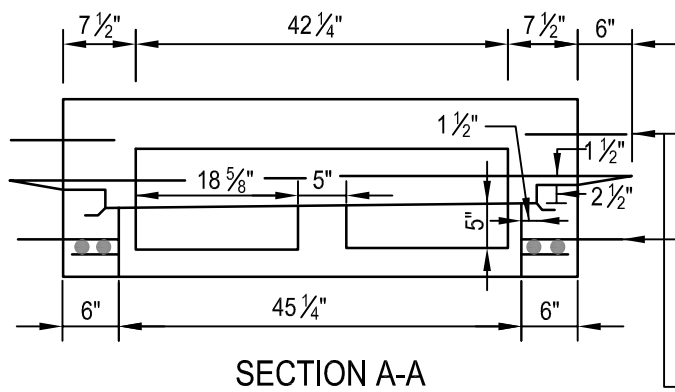
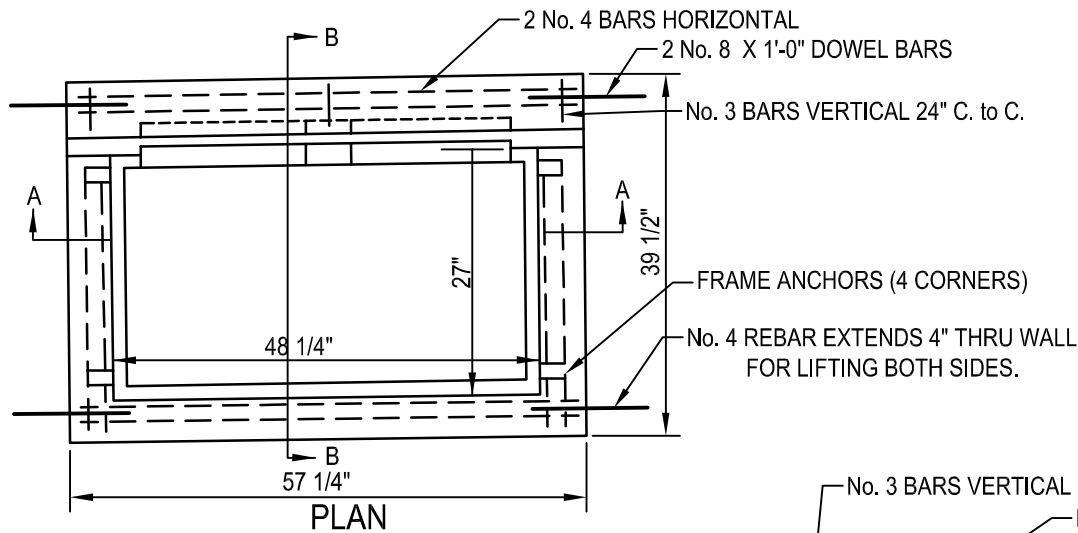
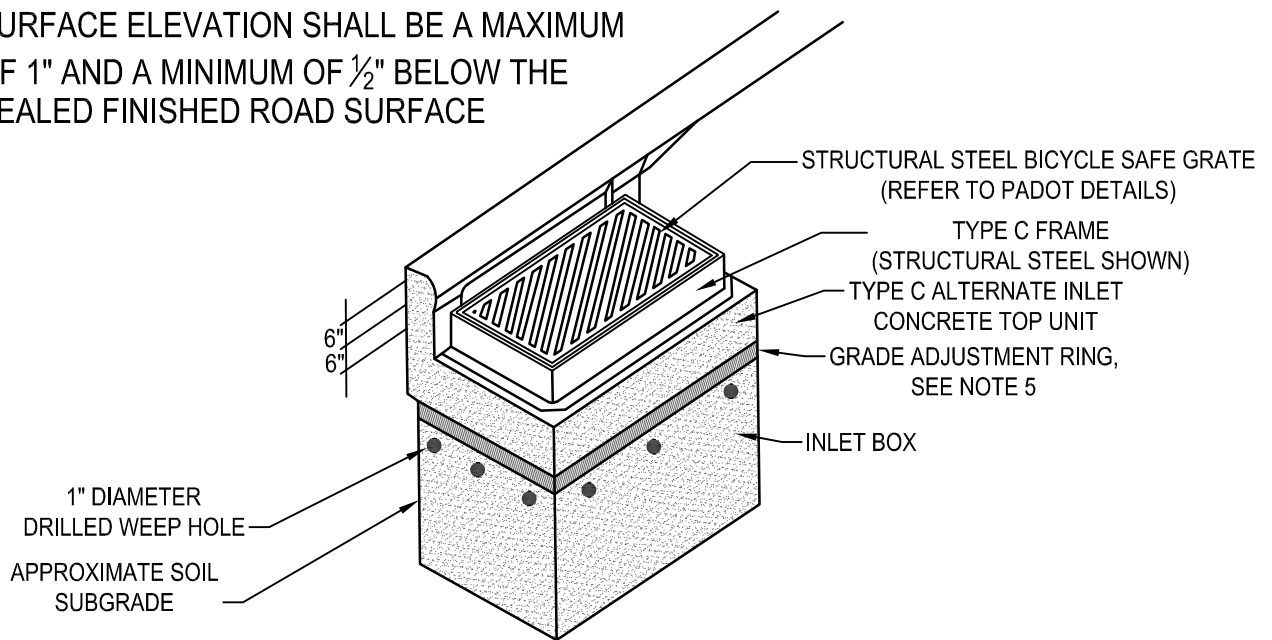

TYPE "C" INLET

NOTE: WHEN LOCATED IN A PAVED STREET, GRATE SURFACE ELEVATION SHALL BE A MAXIMUM OF 1" AND A MINIMUM OF 1/2" BELOW THE SEALED FINISHED ROAD SURFACE

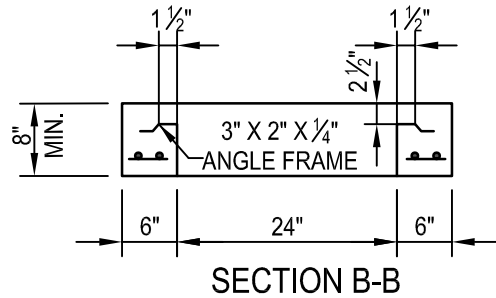
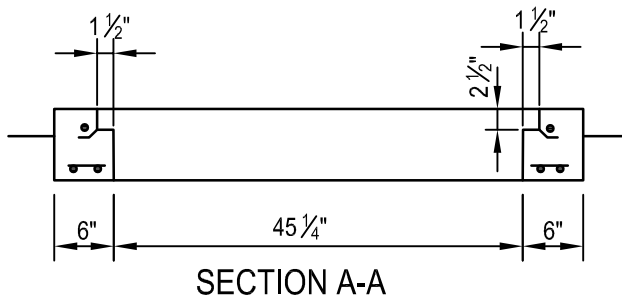
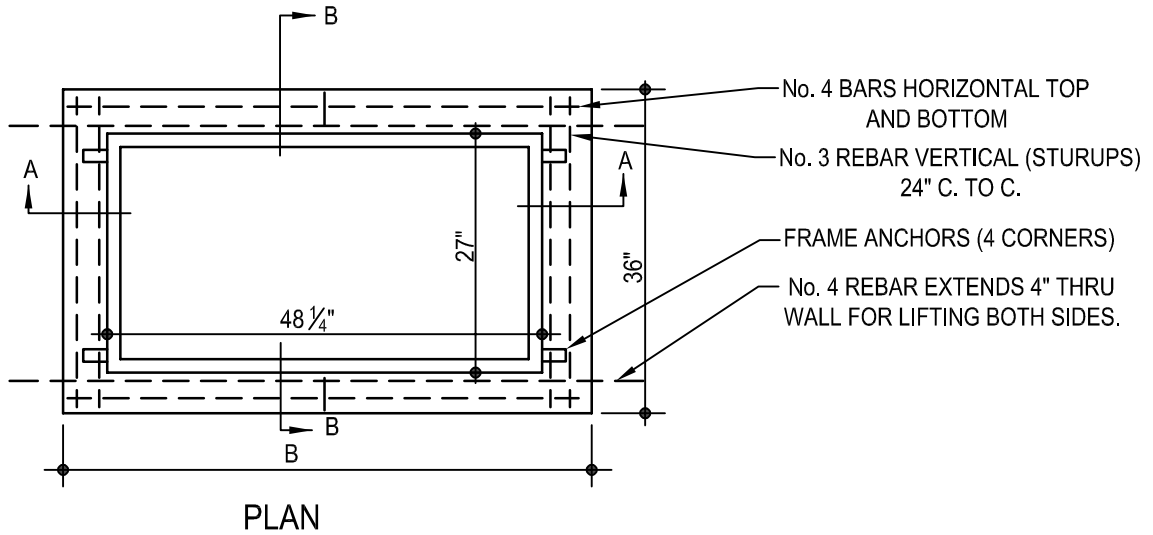
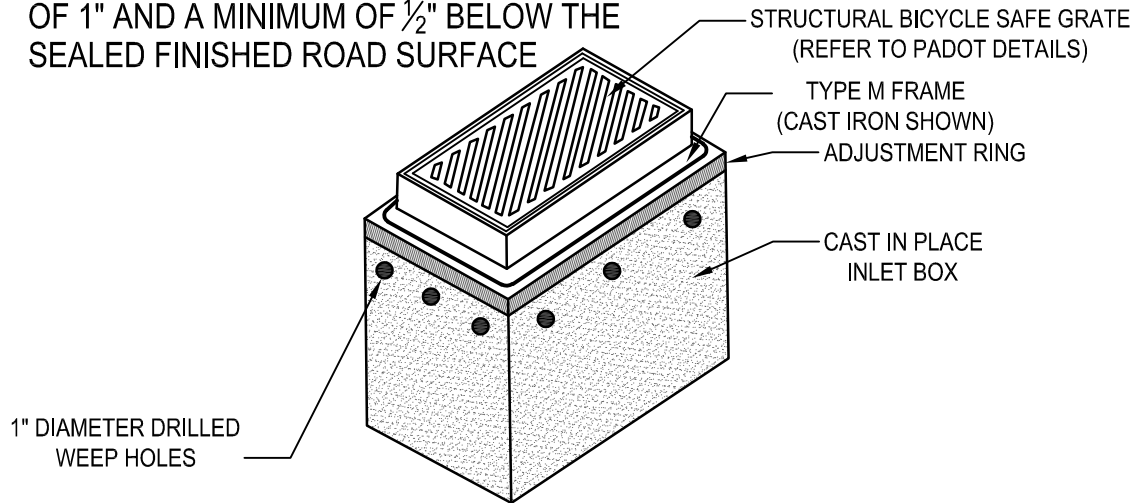

TYPE "M" INLET

BINDER COURSE SHALL BE
INSTALLED TO ALLOW THE WEARING
TO BE FLUSH WITH TOP OF INLET.

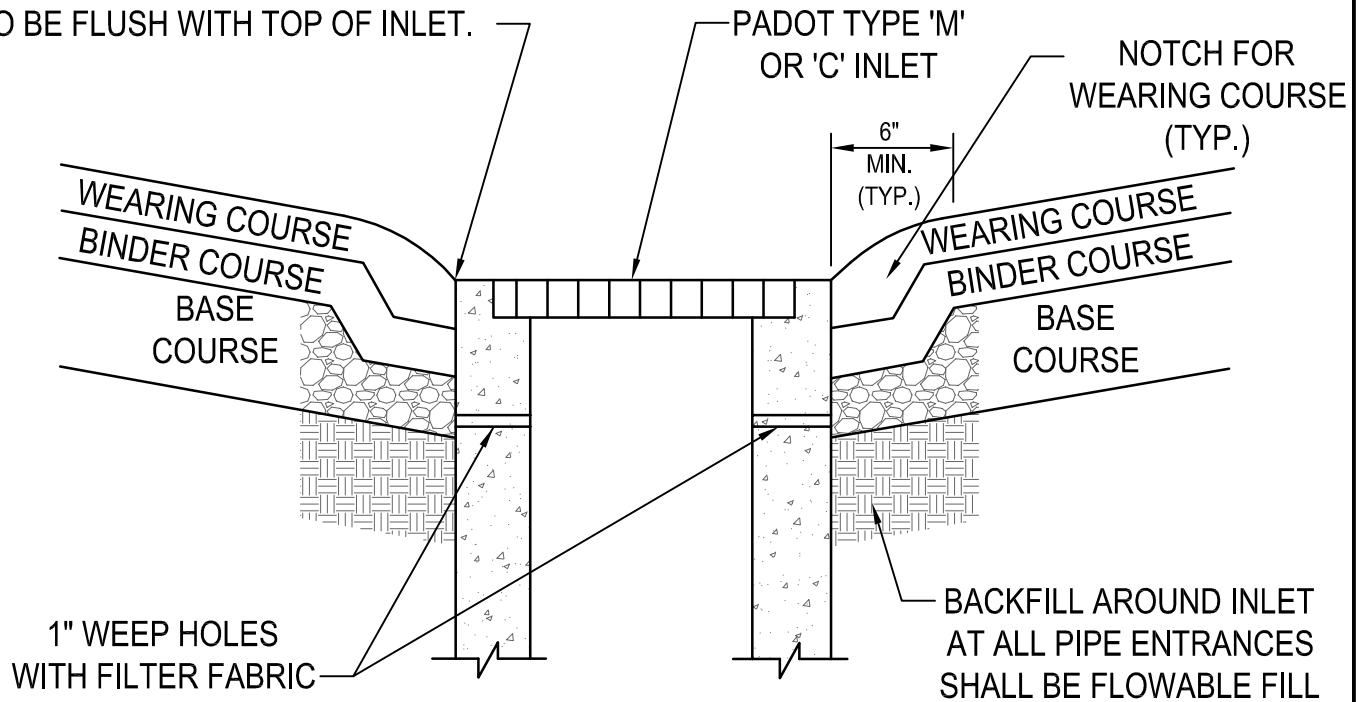

PAVEMENT DETAIL AT INLET LOCATION

NOT TO SCALE

PAVEMENT TREATMENT AT INLET LOCATION

CSE | CLARK SURVEYING
ENGINEERING

83 East Fifth Avenue, Suite 2, Everett, Pennsylvania 15537
Phone: 814.652.2488 Fax: 1.866.381.4127
Website: www.CSE4078.com

WEST PROVIDENCE TOWNSHIP, BEDFORD COUNTY, PENNSYLVANIA

CONSTRUCTION AND MATERIAL SPECIFICATIONS

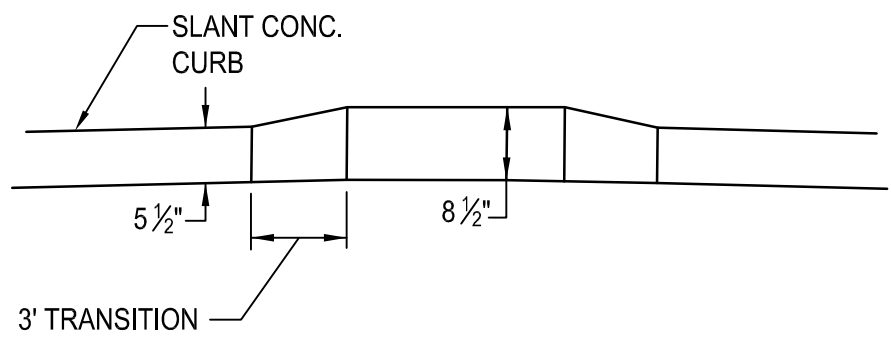
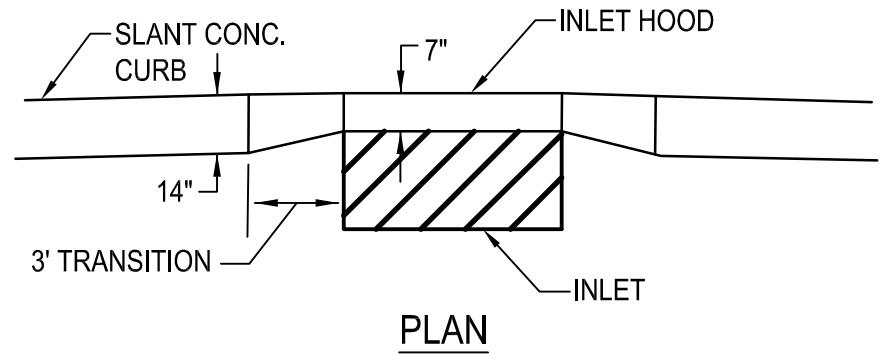

ELEVATION
NOT TO SCALE

SLANT CURB TRANSITION TO TYPE "C" INLET

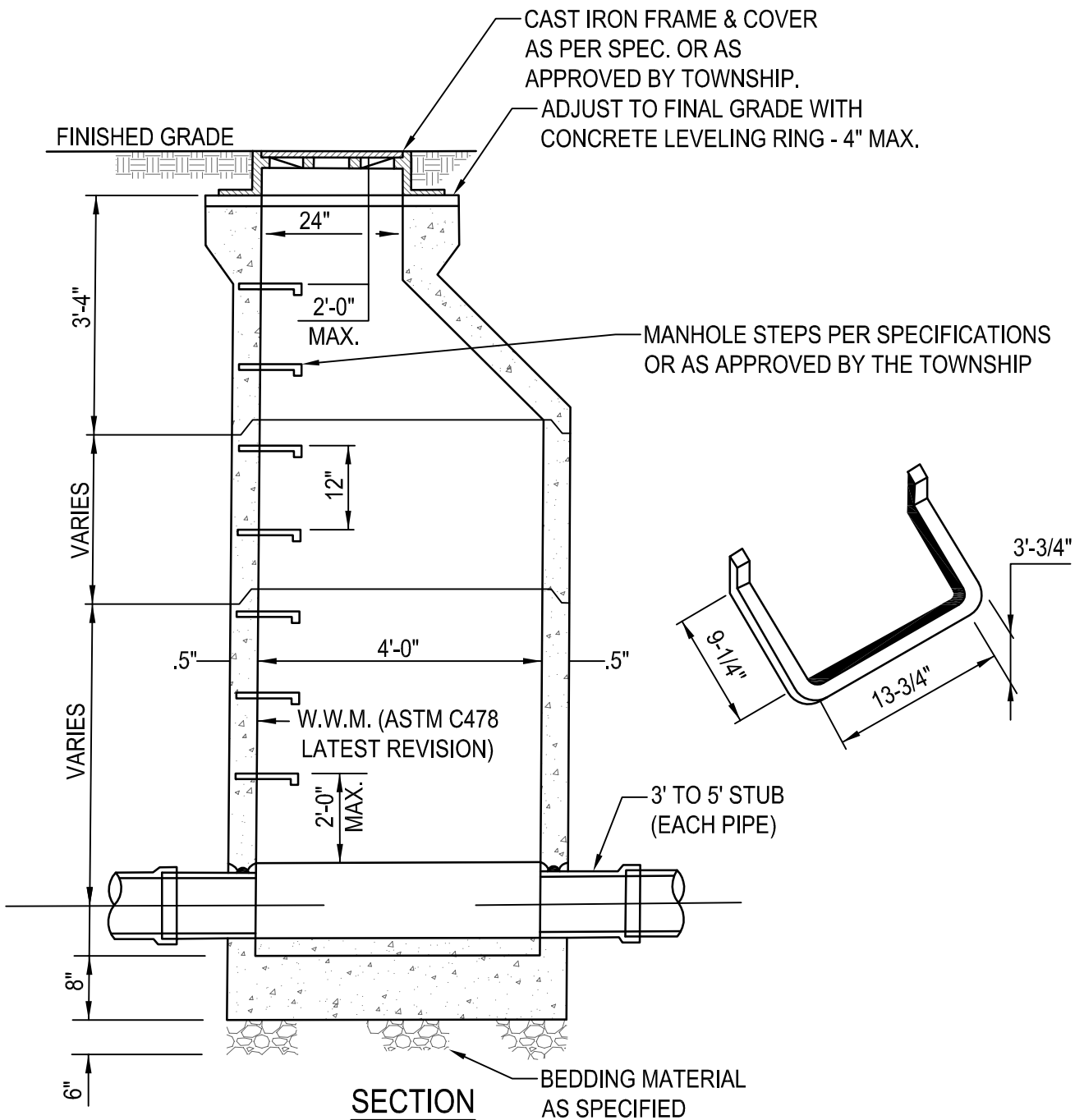

NOTES:

1. ALL JOINTS TO BE SEALED WATERTIGHT WITH RAMNECK OR EQUAL.
2. PRECAST REINFORCED CONCRETE BASE WITH RISER SECTION - CHANNEL FORMED ON JOB WITH GROUT AFTER MANHOLE IS SET AND PIPE STUBS INSTALLED, HOLES FOR PIPE CAST TO SUIT JOB CONDITIONS.
3. PIPE CONNECTION MADE WITH RUBBER GASKET PER ASTM C-443 CAST INTEGRALLY IN MANHOLE BASE.
4. ALL LIFT HOLES SHALL BE PLUGGED WITH AN APPROVED NO SHRINK GROUT.

PRECAST CONCRETE MANHOLE

CSE | CLARK SURVEYING
ENGINEERING

83 East Fifth Avenue, Suite 2, Everett, Pennsylvania 15537
Phone: 814.652.2488 Fax: 1.866.381.4127
Website: www.CSE4078.com

WEST PROVIDENCE TOWNSHIP, BEDFORD COUNTY, PENNSYLVANIA

CONSTRUCTION AND MATERIAL SPECIFICATIONS

R1-1

STOP SIGN

(a) Justification. The Stop Sign (R1-1) is authorized for use on those streets or highways which intersect with a through highway or at a stop intersection so designated by the Department with reference to State-designated highways or local authorities with reference to highways under their jurisdiction. The R1-1 sign is also authorized for use in work zones involving one-lane, two-way roadways in accordance with Publication 203M (relating to work zone traffic control).

(b) Authorization. Before local authorities designate any highway as a through highway or stop intersection which will intersect or affect a State-designated highway, approval of such designation shall first be obtained from the Department. Approval to install R1-1 signs in work areas shall not require the approval of the Department or local authorities when the conditions stipulated in Publication 203M (relating to work zone traffic control) are satisfied.

(c) Placement. The R1-1 sign shall be placed in accordance with Department regulations (relating to location of stop and yield signs), or in accordance with Publication 203M (relating to work zone traffic control). When the number of stop approaches to an intersection is three or more, or two or more at an intersection involving two one-way streets, the Multiway Stop Sign (R1-3) shall be placed below each Stop Sign.

(d) Size. The standard size R1-1 sign shall be 750 mm by 750 mm; however, at intersections on minor roads and secondary streets, a 600 mm by 600 mm sign may be used. In work zones, the standard size R1-1 sign for controlling one-lane, two-way traffic shall be 750 mm by 750 mm.

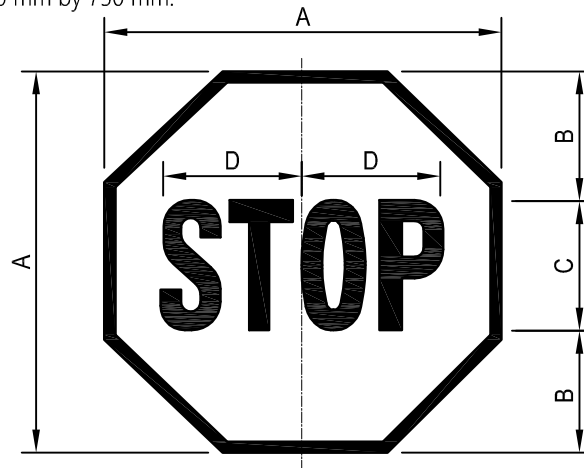

SIGN SIZE AxA	DIMEN. (IN mm)			BOR- DER	BLANK STD.
	B	C	E		
600x600	200	200C	254	15	B1-600
750x750	250	250C	318	20	B1-750
900x900	300	300C	381	20	B1-900
1200x1200	400	400C	508	30	B1-1200

COLOR:

* REDUCE SPACING 40%

LEGEND AND BORDER:
WHITE (REFLECTORIZED)

BACKGROUND:
RED (REFLECTORIZED)

NOTE: THIS DETAIL CREATED FROM DETAIL DATED 10/8/97
BY THE TRAFFIC ENGINEERING AND OPERATIONS DIVISION
BUREAU OF HIGHWAY SAFETY AND TRAFFIC ENGINEERING

STOP SIGN DETAIL

D3-1

STREET NAME SIGN

The Street Name Sign (d3-1) shall be authorized for use as a post mounted sign to identify names of streets for motorists and pedestrians. The D3-1, or other official type of street name sign, should be placed at all street intersections regardless of other route marking that may be present.

When the D3-1 signs are used in business districts, they should be placed at least on the diagonally opposite corner so that they will be on the far right-hand side of the intersection for traffic on the more important street. Signs naming both streets should be erected at each location. They should be mounted with their faces parallel to the streets they name, as close to the corner as practical with the nearest part of each sign not less than 0.3 m, and preferably 0.6 m, back from both curb lines.

In residential districts, D3-1 signs should be mounted as in business districts, but a single location at each intersection shall ordinarily suffice on all but the most important thoroughfares.

The name shall appear on street name signs in capital lettering at least 150 mm high. Larger legend, however, is optional. Lettering 200 mm or greater should be composed of lower-case letters with an initial upper-case letter. The overall width of the sign is variable up to 900 mm width with 150 mm legend. Except when necessary to avoid confusion, suffixes such as "ST", "DR", and "RD", or sections of the city such as "NW" should not be used. When used, this supplemental lettering may be in smaller lettering, at least 100 mm high.

The street name sign should be reflectorized or illuminated and should have a white legend on a green or black background or black legend on a white background or other contrasting colors.

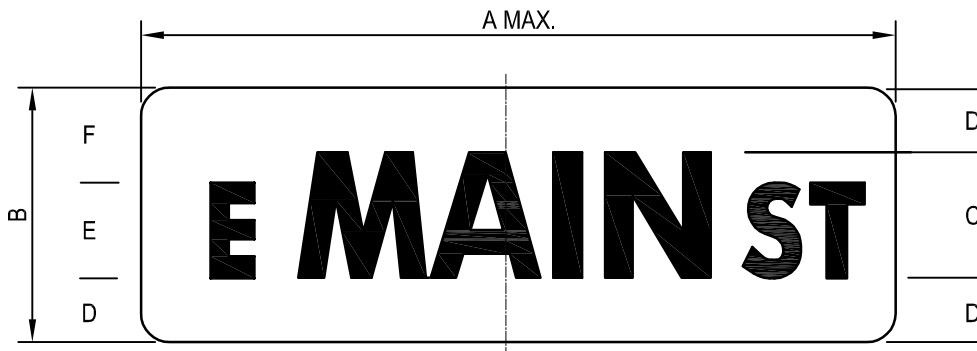

COLOR:

LEGEND:

WHITE (REFLECTORIZED)

BACKGROUND:

GREEN (REFLECTORIZED) OR
BLACK (NON-REFLECTORIZED)

OR

LEGEND:

BLACK (NON-REFLECTORIZED)

BACKGROUND:

WHITE (REFLECTORIZED)

SIGN SIZE AxA	DIMEN. (IN mm)				
	C	D	E	F	G
600x600	150*	25	100*	75	35

* CHOOSE STANDARD ALPHABETS SERIES FOR BEST FIT

NOTE: THIS DETAIL CREATED FROM DETAIL DATED 4/3/97
BY THE TRAFFIC ENGINEERING AND OPERATIONS DIVISION
BUREAU OF HIGHWAY SAFETY AND TRAFFIC ENGINEERING

STREET NAME SIGN DETAIL

CSE | CLARK SURVEYING
ENGINEERING

83 East Fifth Avenue, Suite 2, Everett, Pennsylvania 15537
Phone: 814.652.2488 Fax: 1.866.381.4127
Website: www.CSE4078.com

WEST PROVIDENCE TOWNSHIP, BEDFORD COUNTY, PENNSYLVANIA

CONSTRUCTION AND MATERIAL SPECIFICATIONS

R8-3A

NO PARKING SYMBOL SIGN

(a) Justification. The No Parking Symbol Sign (R8-3A) shall be authorized for use in accordance with Department regulations (relating to justification and description; placement; and size) to prohibit parking along a given highway. If the restriction applies to a limited area or zone, supplemental signs or messages shall be authorized to show the limits of the restriction. Authorized supplemental signs include, but are not limited to the Restricted Hours Panel (R3 20), No Parking Restricted Hours Plaque (R/2), No Parking Loading Zone Plaque (R7-7), Tow Away Zone Sign (R7-201) and No Parking On Pavement Sign (R8 1). As an alternate to the use of supplemental signs, the appropriate supplemental message and the no parking symbol may be incorporated into a single sign.

(b) Size. The standard size R8-3A sign shall be 300mm by 300mm in business, residential, or park areas and 600mm by 600mm in rural areas. The standard size for expressways shall be 900mm by 900mm.

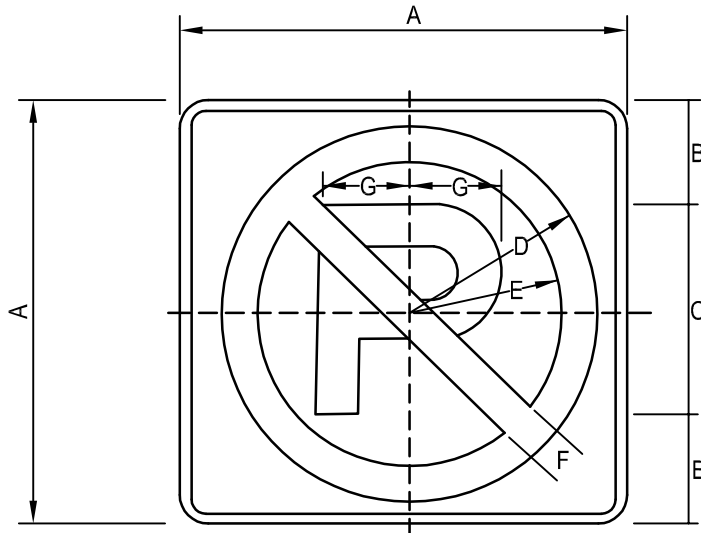

SIGN SIZE AxA	DIMENSIONS (IN MILLIMETERS)						MAR- GIN	BOR- DER	BLANK STD.
	B	C	D	E	F	G			
300 X 300	75	150 E(M)	122	97	25	61	10	10	—
600 X 600	150	300 E(M)	262	212	50	123	10	15	B3-600
900 X 900	225	450 E(M)	395	320	75	182	10	20	B3-900

COLOR:

SYMBOL AND BORDER:
BLACK (NON-REFLECTORIZED)

CIRCLE AND DIAGONAL:
RED (REFLECTORIZED)

BACKGROUND:
WHITE (REFLECTORIZED)

NOTE: THIS DETAIL CREATED FROM DETAIL DATED 4/3/97
BY THE TRAFFIC ENGINEERING AND OPERATIONS DIVISION
BUREAU OF HIGHWAY SAFETY AND TRAFFIC ENGINEERING

NO PARKING SYMBOL SIGN DETAIL

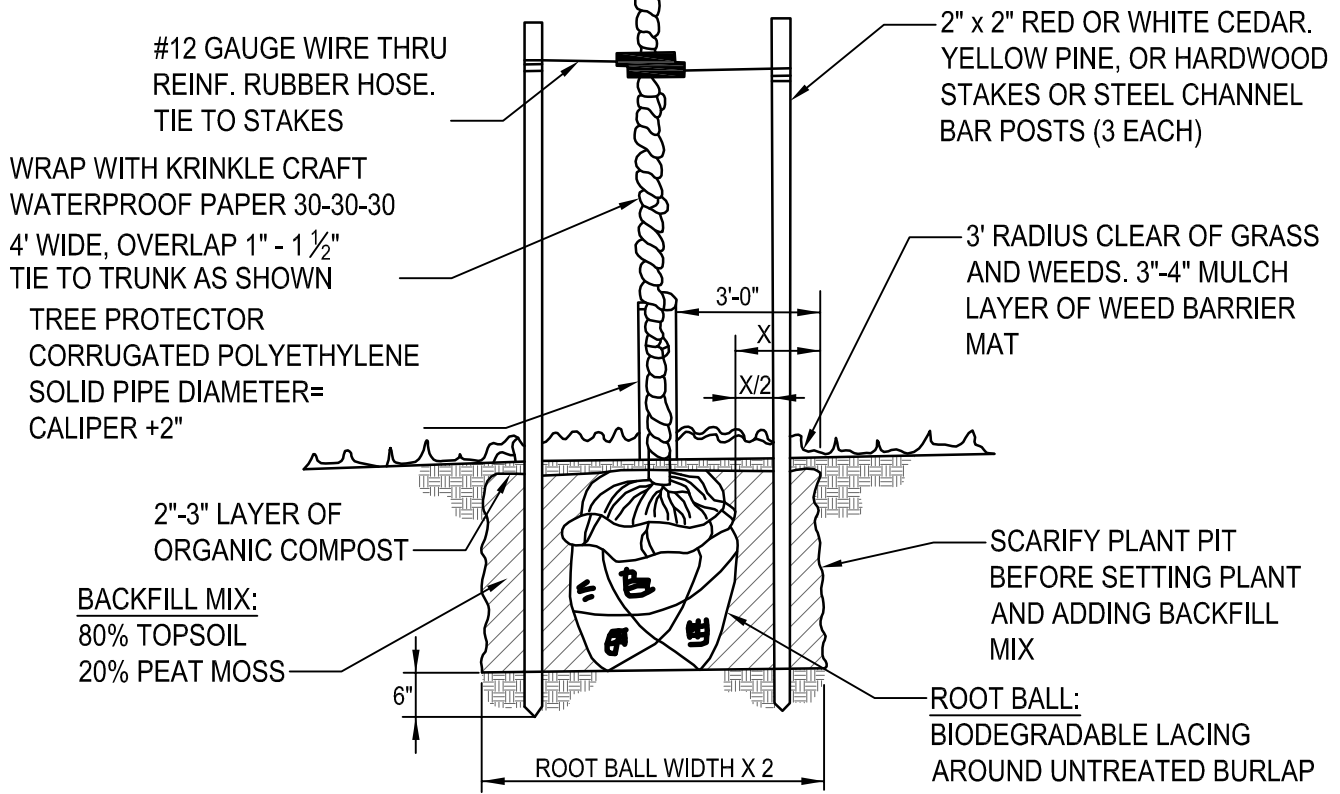
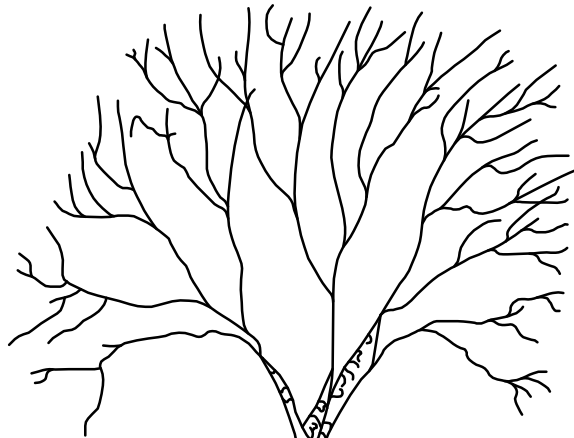

- FERTILIZE WITH 0-20-0 (CLAY SOIL), 20-10-5 OR 16-8-16 (SANDY SOIL) BEFORE MULCHING (1 LB./CU. FT. OF SOIL)
- TREE'S MIN. 10'-0" OFF ROAD R/W.
- SPECIES TO BE SELECTED FROM WEST PROVIDENCE TOWNSHIP APPROVED LIST

PLANTING DETAIL

DECIDUOUS SHADE & FLOWERING TREE DETAIL

CSE | CLARK SURVEYING
ENGINEERING

83 East Fifth Avenue, Suite 2, Everett, Pennsylvania 15537
Phone: 814.652.2488 Fax: 1.866.381.4127
Website: www.CSE4078.com

WEST PROVIDENCE TOWNSHIP, BEDFORD COUNTY, PENNSYLVANIA

CONSTRUCTION AND MATERIAL SPECIFICATIONS

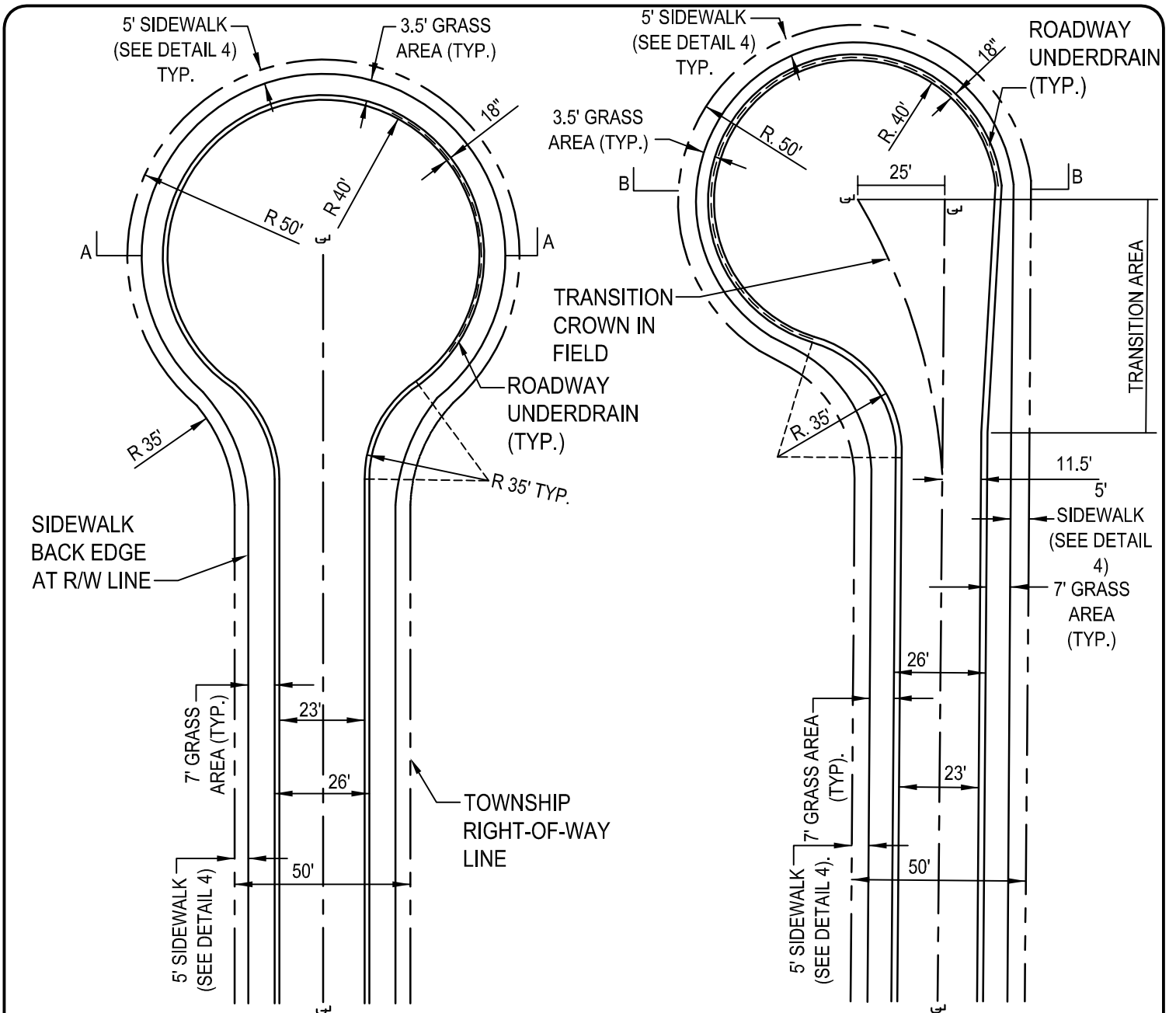

TYPICAL CUL-DE-SAC

NOT TO SCALE

OFFSET CUL-DE-SAC

NOT TO SCALE

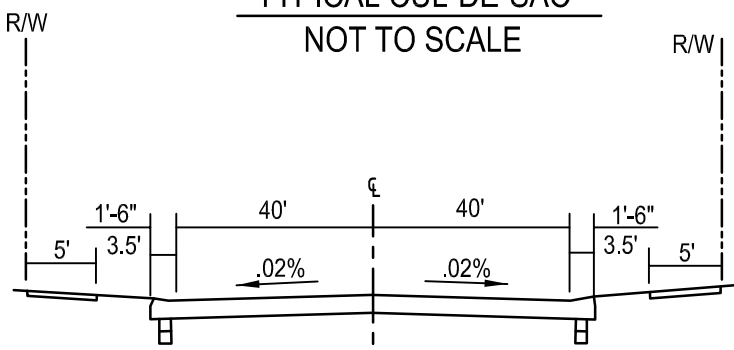

SECTION A-A
NOT TO SCALE

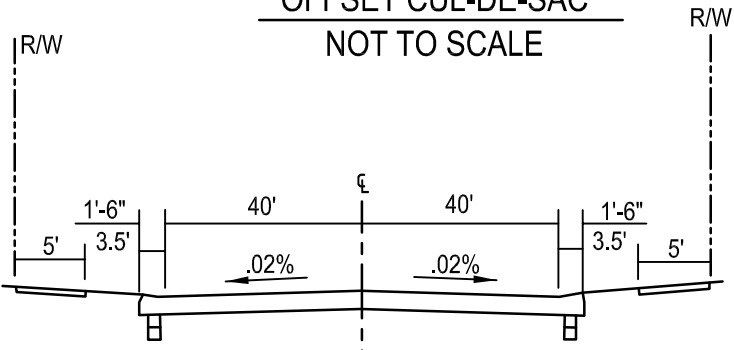

SECTION B-B
NOT TO SCALE

CUL-DE-SAC WITHOUT ISLAND

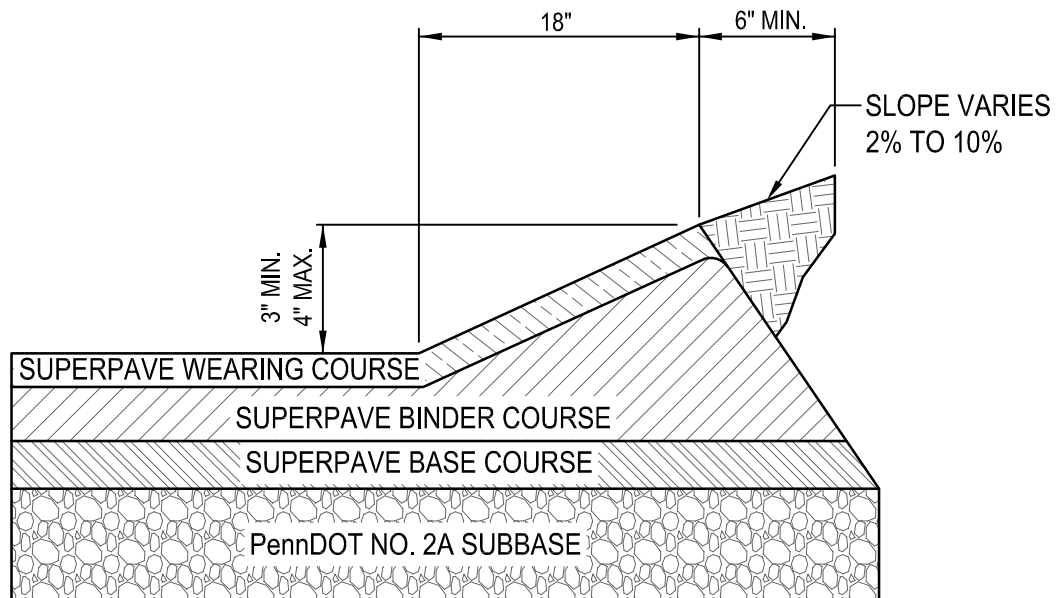

TYPICAL BITUMINOUS CONCRETE WEDGE CURB
NOT TO SCALE

TYPICAL BITUMINOUS CONCRETE WEDGE CURB

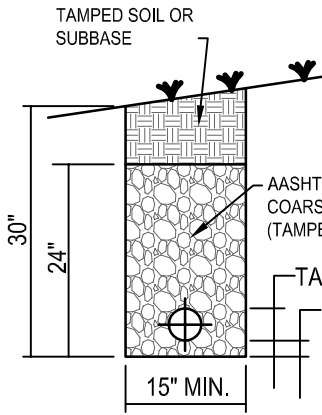

**TYPE 1 BACKFILL
ROCK AND SHALE**

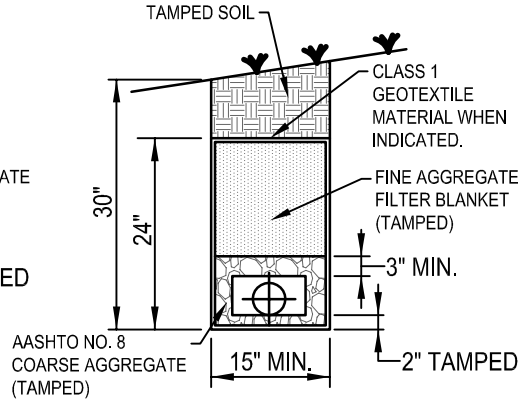

TYPE II BACKFILL SOIL

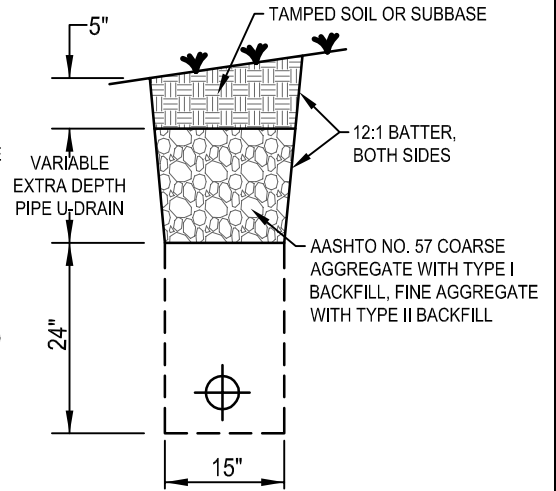

EXTRA DEPTH

NOTES:

1. SLAG IS NOT PERMITTED AS BACKFILL.
2. 100% STONE BACKFILL IS REQUIRED THE FULL WIDTH OF RIGHT-OF-WAY

**PIPE UNDERDRAIN
NOT TO SCALE**

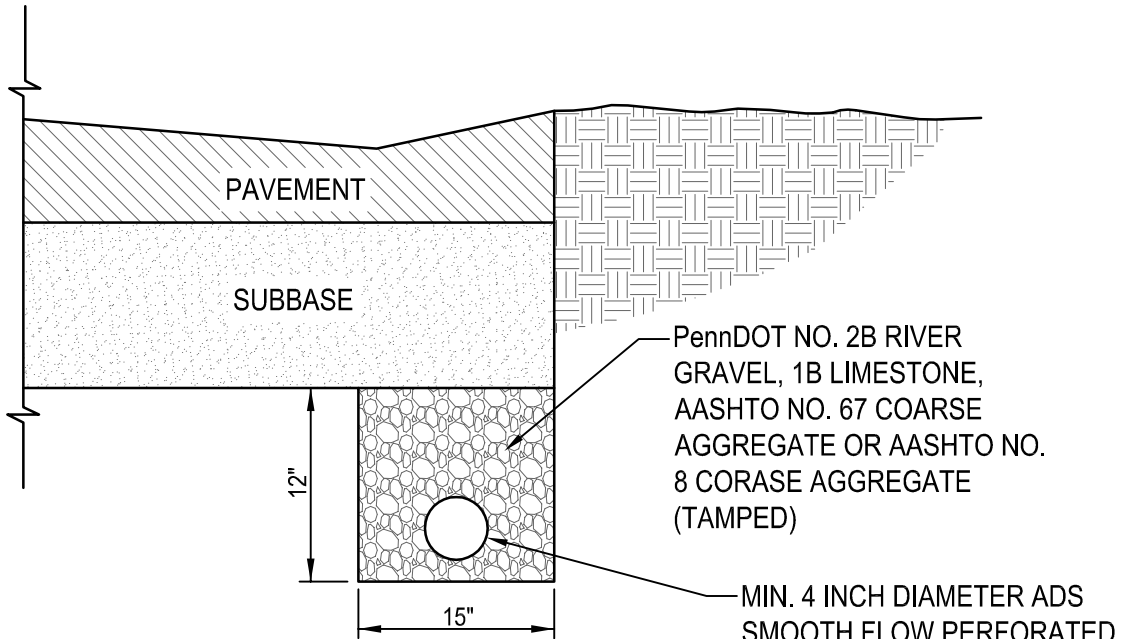

**PAVEMENT BASE DRAIN
NOT TO SCALE**

NOTES:

1. UNDERDRAINS TO BE INSTALLED ON BOTH SIDES OF CARTWAY IN ALL CASES.
2. THE DEVELOPER TO PROVIDE ADDITIONAL UNDERDRAIN AT LOCATIONS AS SPECIFIED BY THE TOWNSHIP.
3. SLAG IS NOT PERMITTED AS BACKFILL.
4. 100% STONE BACKFILL IS REQUIRED THE FULL WIDTH OF RIGHT-OF-WAY.

MIN. 4 INCH DIAMETER ADS SMOOTH FLOW PERFORATED BELL AND SPIGOT UNDERDRAINS. LARGER PIPES MAY BE REQUIRED AT THE DISCRETION OF THE TOWNSHIP.

PIPE UNDERDRAIN/PAVEMENT BASE DRAIN

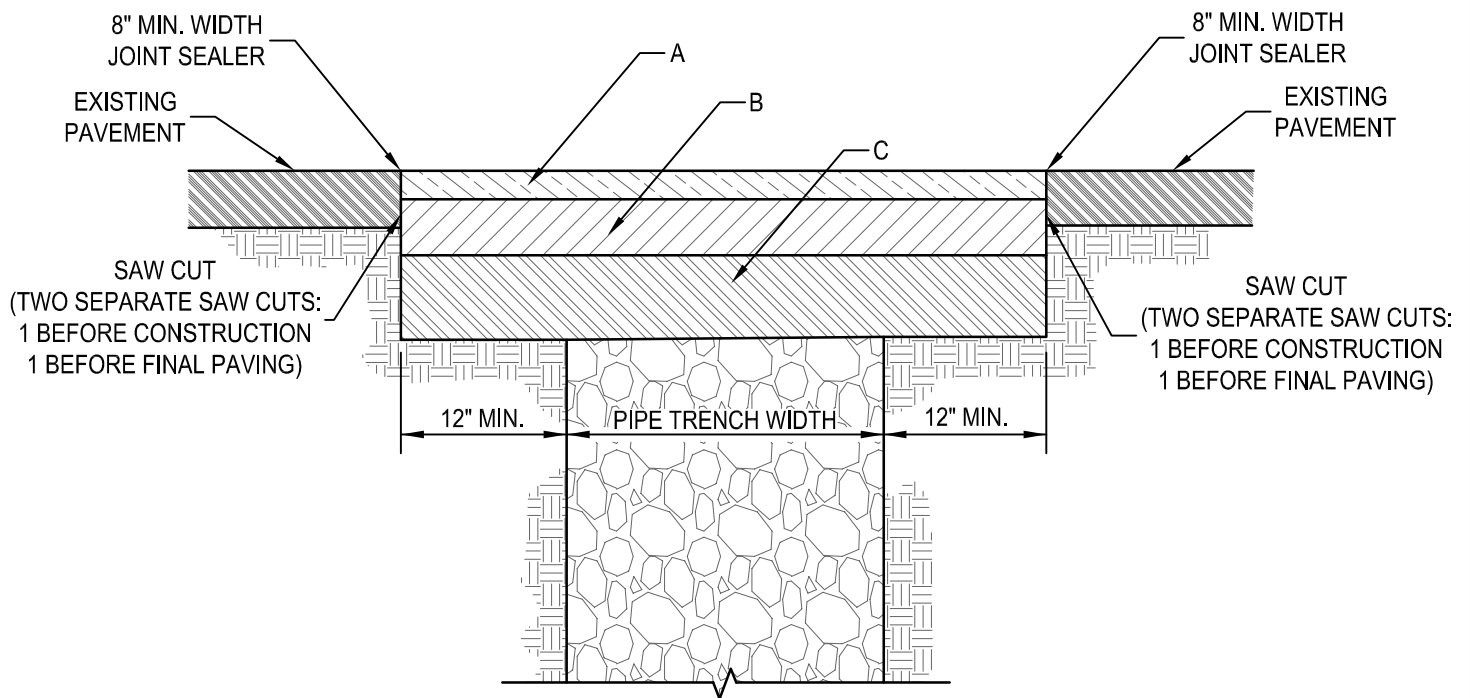

LEGEND

- A. 1-1/2" MIN. (COMPACTED THICKNESS) OR EXISTING THICKNESS, WHICHEVER IS GREATER, OF SUPERPAVE HMA WEARING COURSE, SRL-H (PENNDOT PUB. 408, SECTION 409)
- B. 3" MIN. (COMPACTED THICKNESS) OR EXISTING THICKNESS, WHICHEVER IS GREATER, OF SUPERPAVE HMA BINDER COURSE, SRL-H (PENNDOT PUB. 408, SECTION 409)
- C. 5" MIN. (COMPACTED THICKNESS)(TWO LIFTS) OR EXISTING THICKNESS, WHICHEVER IS GREATER, OF SUPERPAVE HMA BASE COURSE (PENNDOT PUB. 408, SECTION 409)

NOTES

1. DURING COLD WEATHER MONTHS PROVIDE AND MAINTAIN A TEMPORARY BITUMINOUS COLD PATCH SURFACE UNTIL WEATHER PERMITS SUPERPAVE HMA PAVING,
2. TOWNSHIP ROADMASTER MUST BE NOTIFIED 72 HOURS IN ADVANCE OF ROAD OPENING AND SURFACING.
3. SLAG IS NO PERMITTED AS BACKFILL WITHIN TOWNSHIP RIGHT-OF-WAYS OR EASEMENTS.
4. 100% 2A STONE BACKFILL IS REQUIRED THE FULL WIDTH OF THE RIGHT-OF-WAY. TEMPORARY PIPE BACKFILL USING EXCAVATED MATERIAL IS NOT PERMITTED.
5. ALL UTILITY CROSSINGS MUST BE MADE PERPENDICULAR TO THE CENTERLINE OF THE CARTWAY.
6. FOR PIPE BEDDING AND BACKFILL MATERIALS SEE DETAILS RSD-2, RSD-3 AND RSD-4.
7. ASPHALY MIX DESIGN MUST BE SUBMITTED TO TOWNSHIP FOR APPROVAL A MINIMUM OF 72 HOURS PRIOR START OF WORK.

SUPERPAVE HMA TRENCH REPAIR

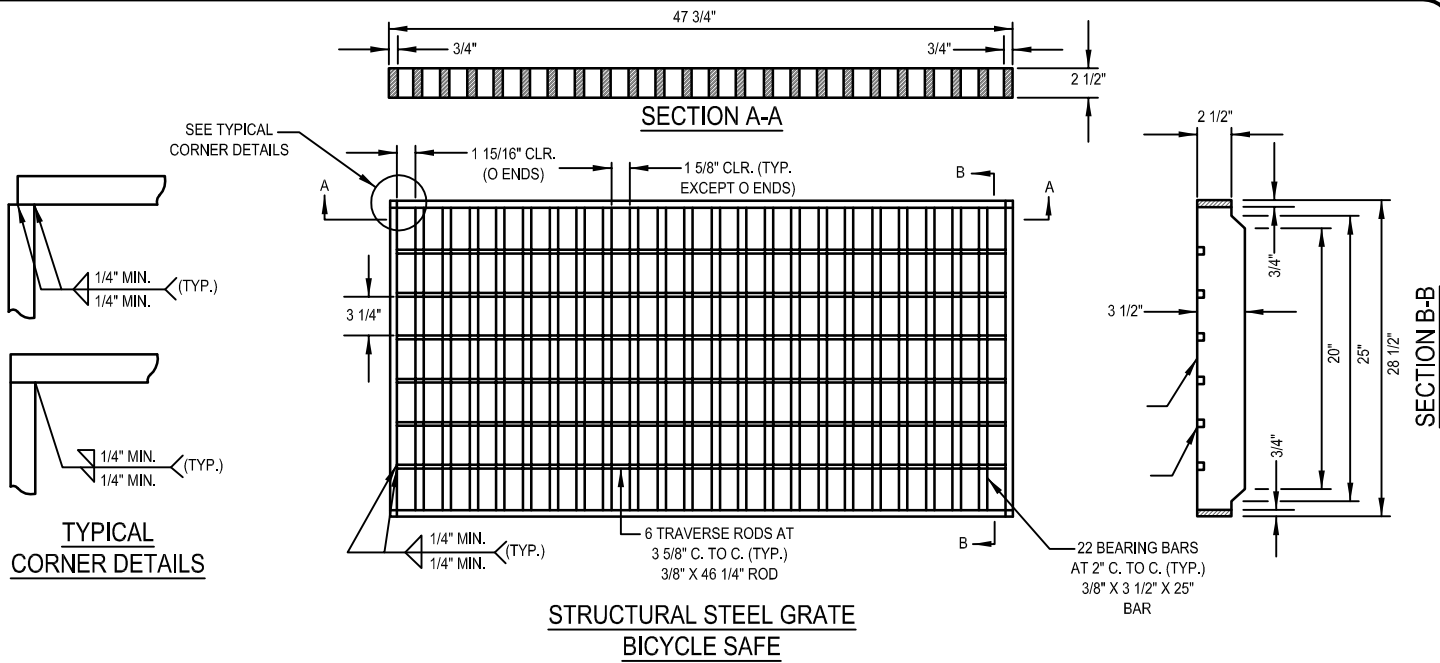

**TYPICAL
CORNER DETAILS**

NOTES

1. THIS SHEET DEPICTS THE DIMENSIONS REQUIRED FOR UNIFORMITY AND INTERCHANGEABILITY. IT DOES NOT INCLUDE DETAILS REQUIRED FOR FABRICATION OR MANUFACTURING. ONLY GRATES SUPPLIED BY A MANUFACTURER LISTED IN PennDOT BULLETIN 15 SHALL BE PERMITTED
2. WELD STRUCTURAL STEEL GRATES IN ACCORDANCE WITH THE REQUIREMENTS OF PUBLICATION 408, SECTION 1105.
3. WELD STRUCTURAL STEEL FRAMES IN ACCORDANCE WITH PUBLICATION 408, SECTION 1105. COAT FRAMES WITH AN APPROVED BITUMINOUS PAINT, IN ACCORDANCE WITH PUBLICATION 408 SECTION 605.2(f). AS AN ALTERNATE TO BITUMINOUS PAINT, GALVANIZE FRAMES IN ACCORDANCE WITH PUBLICATION 408, SECTION 1105.2(s).
4. PROVIDE TRANSVERSE RODS, MEETING THE REQUIREMENTS OF PUBLICATION 408.
5. PROVIDE STRUCTURAL STEEL GRATES WITH THE GRATE SPACERS LOCATED FLUSH ALONG THE TOP SURFACE OF THE GRATE.
6. DO NOT USE CAST IRON CRATES OR FRAMES WITHIN THE TOWNSHIP ROADWAYS.
7. SOURCE: PENNDOT STANDARDS FOR ROADWAY CONSTRUCTION, RC-45M (LATEST EDITION)

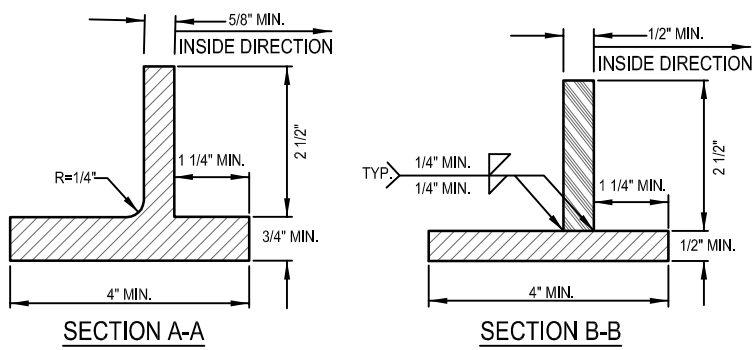
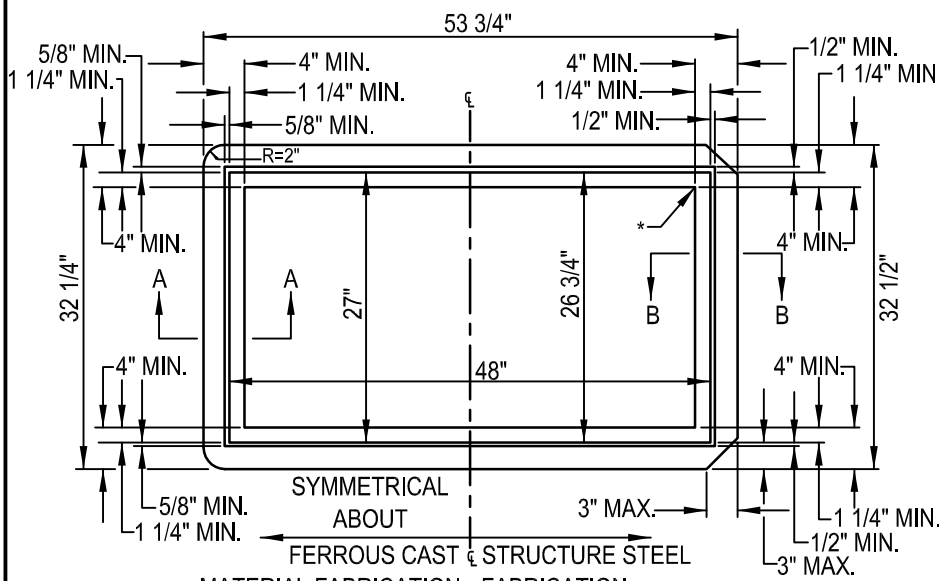

TYPE M INLET (FRAME & BICYCLE SAFE GRATE)

CONSTRUCTION NOTES

1. ALL OFF-STREET PARKING AREAS OF MORE THAN FIVE (5) VEHICLES AND (2) ACCESS DRIVES LEADING TO THE PARKING AREA WHICH ARE ACCESSIBLE TO THE GENERAL PUBLIC SHALL BE GRADED FOR PROPER DRAINAGE AND CONSIST OF A STABLE/SLIP RESISTANT MATERIAL.
2. HANDICAPPED ACCESSIBLE PARKING SPACES SHALL BE PROVIDED FOR PARKING AREAS PER SECTION 702.9.E OF THE WEST PROVIDENCE TOWNSHIP SUBDIVISION AND LAND DEVELOPMENT ORDINANCE.
3. ALL PARKING AREAS GREATER THAN 20,000 S.F. SHALL INCLUDE INTERIOR LANDSCAPING OF AT LEAST 10% OF THE PARKING AREA PER SECTION 702.9.E.2.

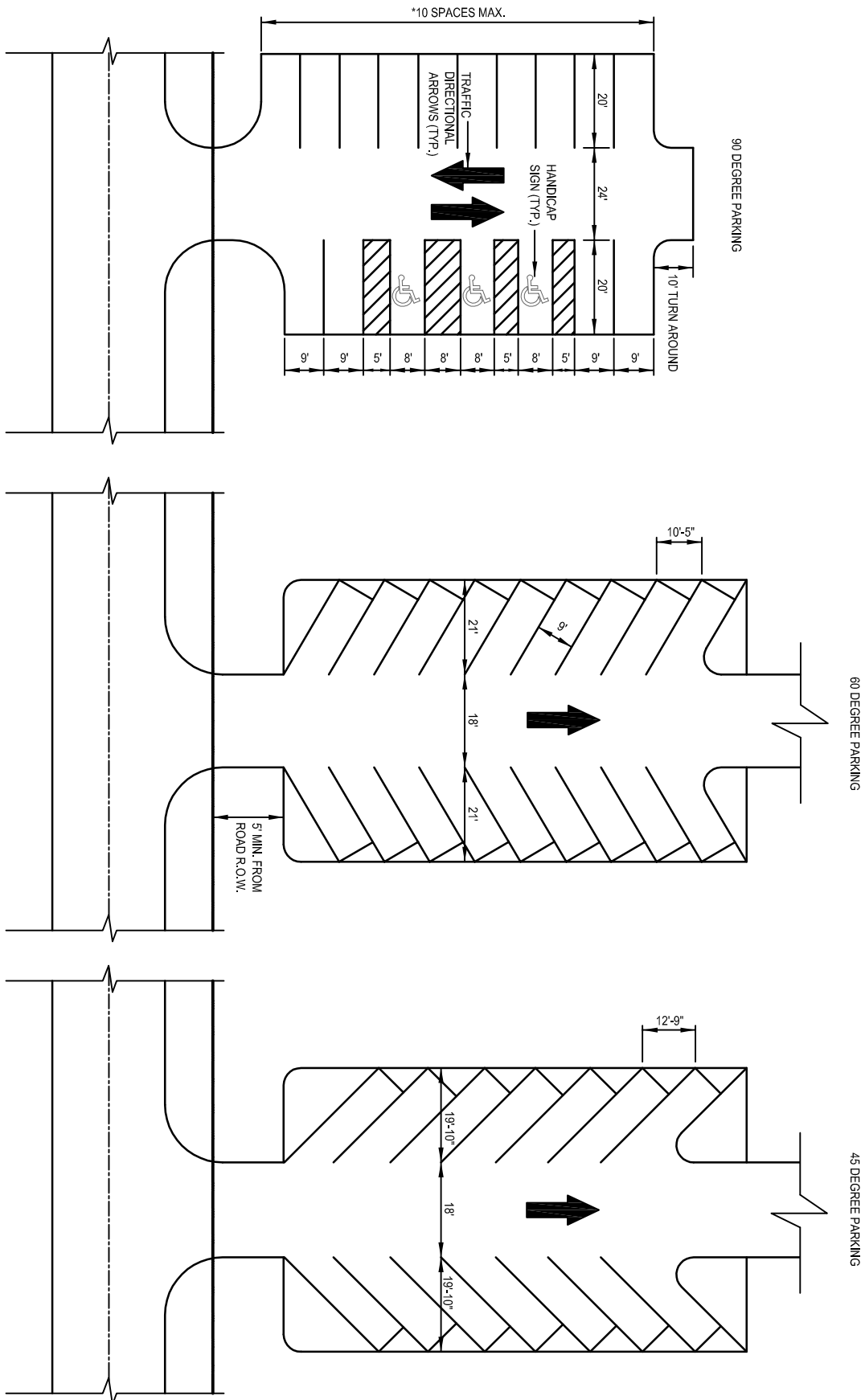

PARKING CONFIGURATIONS

**CERTIFICATE FOR APPROVAL BY THE
WEST PROVIDENCE TOWNSHIP SUPERVISORS**

APPROVED BY RESOLUTION OF THE WEST PROVIDENCE
TOWNSHIP BOARD OF SUPERVISORS ON THIS _____ DAY OF
_____, 20_____.

(CHAIRMAN)

(SECRETARY)

**CERTIFICATE FOR APPROVAL BY THE
WEST PROVIDENCE TOWNSHIP PLANNING COMMISSION**

APPROVED BY RESOLUTION OF THE WEST PROVIDENCE
TOWNSHIP BOARD OF SUPERVISORS ON THIS _____ DAY OF
_____, 20_____.

(CHAIRMAN)

(SECRETARY)

**CERTIFICATE OF REVIEW BY
BEDFORD COUNTY PLANNING COMMISSION**

REVIEWED BY THE BEDFORD COUNTY PLANNING COMMISSION
THIS _____ DAY OF _____, 20_____.

(DIRECTOR)

SURVEYOR'S CERTIFICATE

I HEREBY CERTIFY THAT THIS SURVEY AND PLAN ARE CORRECT AS
SHOWN TO THE BEST OF MY KNOWLEDGE AND BELIEF.

(SIGNATURE)

(DATE)

(LICENSE NO.)

CERTIFICATE OF OWNERSHIP

COMMONWEALTH OF PENNSYLVANIA
COUNTY OF BEDFORD
ON THIS, THE _____ DAY OF _____, 20_____, BEFORE ME,
THE UNDERSIGNED OFFICER, PERSONALLY APPEARED _____,
WHO BEING DULY SWORN ACCORDING TO LAW, DEPOSES AND SAYS THAT THEY
ARE THE OWNER AND/OR EQUITABLE OWNER OF THE PROPERTY SHOWN ON THIS
PLAN, AND THAT THEY ACKNOWLEDGE THE SAME TO BE THEIR PLAN, AND THAT
THEY DESIRE THE SAME TO BE RECORDED AS SUCH ACCORDING TO LAW.

(OWNER SIGNATURE)

NOTARIZATION:

SWORN TO AND SUBSCRIBED TO BEFORE ME THIS _____ DAY OF _____, 20____

NOTARY PUBLIC

STATE OF: _____

COUNTY OF: _____

MY COMMISSION EXPIRES: _____

TYPICAL SIGNATURE BLOCK

APPENDIX C

Appendix c
Recommended Tree and Shrub List
Landscape Plans for West Providence Township
Bedford County, Pennsylvania

Native Trees

Height in Feet at Maturity	Scientific Name	Common Name
40	<i>Acer pensylvanicum</i>	Striped Maple
40	<i>Acer rubrum</i>	Red Maple
30	<i>Amelanchier canadensis</i>	Shadbush, Serviceberry
25	<i>Amelanchier laevis</i>	Shadblow, Shadbush
40	<i>Aralia spinosa</i>	Devil's Walking Stick
35	<i>Asimina triloba</i>	Pawpaw
60	<i>Betula lenta</i>	Sweet or Black Birch
70	<i>Betula lutea</i>	Yellow Birch
40	<i>Betula nigra</i>	River Birch
35	<i>Carpinus caroliniana</i>	Hornbeam, Ironwood
85	<i>Carya cordiformis</i>	Bitternut Hickory
85	<i>Carya glabra</i>	Pignut Hickory
85	<i>Carya laciniosa</i>	Shellbark Hickory
85	<i>Carya ovalis</i>	Sweet Pignut/Red Hickory
85	<i>Carya ovata</i>	Shagbark Hickory
85	<i>Carya tomentosa</i>	Mockernut Hickory
75	<i>Castanea dentate*</i>	American Chestnut
90	<i>Celtis occidentalis</i>	Common Hackberry
35	<i>Cercis canadensis</i>	Eastern Redbud
35	<i>Cornus alternifolia</i>	Pagoda Dogwood
35	<i>Cornus florida</i>	Flowering Dogwood
35	<i>Crataegus crusgalli</i>	Cockspur Hawthorn
20	<i>Crataegus pruinosa</i>	Frosted Hawthorn
30	<i>Crataegus punctata</i>	Dotted Hawthorn
60	<i>Diospyros virginiana</i>	Common Persimmon
60	<i>Gleditsia triacanthos</i>	Common Honeylocust
45	<i>Ilex opaca</i>	American Holly
75	<i>Juglans cinerea</i>	Butternut
60	<i>Juniperus virginiana</i>	Eastern Red Cedar
90	<i>Liquidambar styraciflua</i>	Sweet Gum
90	<i>Liriodendron tulipifera</i>	Tulip Tree/Tulip Poplar
90	<i>Magnolia acuminata</i>	Cucumbertree Magnolia
35	<i>Malus coronaria</i>	American crabapple
50	<i>Morus rubra</i>	Red Mulberry
60	<i>Nyssa sylvatica</i>	Black Gum
40	<i>Ostrya virginiana</i>	Hop Hornbeam
60	<i>Picea glauca</i>	White Spruce
75	<i>Pinus pungens</i>	Table Mountain Pine
75	<i>Pinus rigida</i>	Pitch Pine

Native Trees, continued

Height in Feet at Maturity	Scientific Name	Common Name
70	<i>Pinus strobus</i>	White Pine
90	<i>Platanus x acerifolia</i> (hybrid)	London Planetree
35	<i>Prunus americana</i>	American Plum
80	<i>Prunus serotina</i>	Black Cherry
35	<i>Ptelea trifoliata</i>	Common Hoptree
90	<i>Quercus alba</i>	White Oak
90	<i>Quercus bicolor</i>	Swamp White Oak
90	<i>Quercus borealis</i>	Northern Red Oak
80	<i>Quercus coccinea</i>	Scarlet Oak
70	<i>Quercus ellipsoidalis</i>	Northern Pin Oak
20	<i>Quercus ilicifolia</i>	Scrub Oak
50	<i>Quercus imbricaria</i>	Shingle Oak
60	<i>Quercus macrocarpa</i>	Bur Oak
45	<i>Quercus marilandica</i>	Blackjack Oak
80	<i>Quercus montana</i>	Chestnut Oak
50	<i>Quercus muhlenbergi</i>	Chinkapin Oak
20	<i>Quercus prinoides</i>	Dwarf Chinkapin Oak
60	<i>Quercus rubra</i>	Red Oak
60	<i>Quercus shumardii</i>	Shumark Oak
50	<i>Quercus prinus</i>	Chestnut Oak
80	<i>Quercus velutina</i>	Black Oak
50	<i>Sassafras albidum</i>	Common Sassafras
50	<i>Thuja occidentalis</i>	Eastern Arborvitae
90	<i>Tilia americana</i>	American Linden
90	<i>Tsuga canadensis</i> *	Canada Hemlock
90	<i>Ulmus americana</i> *	American Elm
90	<i>Ulmus rubra</i>	Slippery/Red Elm
35	<i>Viburnum lentago</i>	Nannyberry Viburnum
35	<i>Viburnum prunifolium</i>	Black Haw

- *Purchase only when resistant cultivar is available
- Note: All ash trees are susceptible to the emerald ash borer and should not be planted until a resistant cultivar is available

Native Shrubs

Height in Feet at Maturity	Scientific Name	Common Name
30	<i>Alnus serrulata</i>	Common Alder
9	<i>Aronia arbutifolia</i>	Red Chokeberry
8	<i>Aronia melanocarpa</i>	Black Chokeberry
12	<i>Aronia prunifolia</i>	Purplefruit Chokeberry
5	<i>Callicarpa Americana</i>	Beautyberry
12	<i>Calycanthus floridus</i>	Sweetshrub
3	<i>Ceanothus americanus</i>	Jerseytea Ceanothus
10	<i>Cephalanthus occidentalis</i>	Buttonbush
18	<i>Clethra acuminata</i>	Summersweet
18	<i>Clethra alnifolia</i>	Summersweet
9	<i>Cornus amomum</i>	Silky Dogwood
12	<i>Cornus racemosa</i>	Gray Dogwood
12	<i>Cornus rugosa</i>	Roundleaf Dogwood
10	<i>Cornus stolonifera</i>	Red Osier Dogwood
12	<i>Corylus Americana</i>	American Filbert/Hazelnut
12	<i>Corylus cornuta</i>	Beaked Filbert
3	<i>Diervilla lonicera</i>	Dwarf Bushhoneysuckle
9	<i>Dirca palustris</i>	Atlantic Leatherwood
15	<i>Hamamelis virginiana</i>	Witch Hazel
6	<i>Hydrangea arborescens</i>	Smooth Hydrangea
3	<i>Hypericum prolificum</i>	Shrubby St. Johnswort
3-9	<i>Itea virginica</i>	Sweetspire
9	<i>Ilex glabra</i>	Inkberry
10	<i>Ilex verticillata</i>	Winterberry Holly
6	<i>Kalmia latifolia</i>	Mountain Laurel
8	<i>Lindera benzoin</i>	Spicebush
6	<i>Lonicera canadensis</i>	American Fly Honeysuckle
12	<i>Lyonia ligustrina</i>	He-huckleberry
12	<i>Physocarpus opulifolius</i>	Common Ninebark
15	<i>Rhododendron arborescens</i>	Sweet Azalea
10	<i>Rhododendron canadense</i>	Catawba Rhododendron
20	<i>Rhododendron maximum</i>	Rosebay Rhododendron
9	<i>Rhododendron roseum</i>	Roseshell Azalea
6	<i>Rhododendron nudiflorum</i>	Pinxterbloom Azalea
6	<i>Rhododendron viscosum</i>	Swamp Azalea
8	<i>Rhus aromatica</i>	Fragrant Sumac
20	<i>Rhus copallina</i>	Flameleaf Sumac
15	<i>Rhus glabra</i>	Smooth Sumac
20	<i>Rhus typhina</i>	Staghorn Sumac
6	<i>Ribes americanum</i>	American Black Currant

Native Shrubs, continued

Height in Feet at Maturity	Scientific Name	Common Name
6	<i>Ribes cynobati</i>	Pasture Gooseberry
4	<i>Rosa Carolina</i>	Carolina Rose
12	<i>Salix humilis</i>	Prairie Willow
20	<i>Salix lucida</i>	Shining Willow
12	<i>Sambucus canadensis</i>	Elderberry
12	<i>Sambucus pubens</i>	Scarlet Elder
6	<i>Spirea alba</i>	Narrowleaf Meadowsweet Spirea
4	<i>Spirea corymbosa</i>	Corymed Spirea
6	<i>Spirea tomentosa</i>	Hardhack Spirea
12	<i>Staphylea trifolia</i>	American Bladdernut
6	<i>Symphoricarpos albus leavigatus</i>	Snowberry
5	<i>Symphoricarpos orbiculatus</i>	Coralberry
6	<i>Taxus Canadensis</i>	Canada Yew
2	<i>Vaccinium angustifolium</i>	Lowbush Blueberry
6	<i>Vaccinium corymbosum</i>	Highbush Blueberry
12	<i>Vaccinium stamineum</i>	Common Deerberry
5	<i>Viburnum acerifolium</i>	Mapleleaf Viburnum
6	<i>Viburnum cassinoides</i>	Witherod
10	<i>Viburnum dentatum</i>	Arrowwood
15	<i>Viburnum nudum</i>	Smooth Witherod
10	<i>Viburnum rafinesquianum</i>	Rafinesque Viburnum
10	<i>Viburnum trilobum</i>	American Cranberrybush Viburnum
6	<i>Yucca filamentosa</i>	Adamsneedle Yucca

The following resources provide additional information:

1. <http://findnativeplants.com/mid-atlantic/pennsylvania-native-plants/>
This site lists the nurseries in Pennsylvania that sell native plants.
2. Hightshoe, Gary L. Native Trees, Shrubs, and Vines for Urban and Rural America 1988. John Wiley & Sons. New York.
3. Rhoads, Ann and Block, Timothy. The Plants of Pennsylvania. 2007. Univ. of Pennsylvania Press. Philadelphia.
4. Vincent Cotrone
Urban Forester
Penn State Cooperative Extension
16 Luzerne Avenue, Suite 200
West Pittston, PA 18643
(570) 825-1701
(570) 825-1709 fax
vjc1@psu.edu
<http://www.patrees.org/>